



威乐中国官方微信



威乐中国官方微博

Catalogue-50Hz-2018

WILO HOUSEHOLD PUMPS

德国威乐生活用水泵

We bring water where you need!

Upgrade your water & life with WILO pumps

Wilo-Household Pumps/1803/EN/CHN

威乐中国总部
威乐（中国）水泵系统有限公司

地址：
北京市顺义区赵全营兆丰工业区兆丰二街10号
101300
电话：010-52347828 010-52347838
传真：010-52347827
[Http://www.wilo.com.cn](http://www.wilo.com.cn)

本资料全部内容属于威乐（中国）水泵系统有限公司所有，未经本公司书面许可，任何单位及个人不得以任何形式转载。



公司介绍 Company Profile

Wilo

Pioneering for You.

We are there for you worldwide

Wilo China Ltd. was founded in 2000 as an important subsidiary of Wilo SE worldwide. At present, Wilo China has 14 branches and over 600 employees. Led by several HVAC doctors, a professional team of Wilo China devotes to developing and promoting the products and solutions that can meet the local requirements of Chinese customers.

Wilo SE, founded in 1872, headquartered in Dortmund, is one of the world's leading manufacturers and providers of pumps and pump systems for heating, air-conditioning and cooling, for water supply and sewage disposal. With over 7,000 employees and 60 production and sales companies all over the world, we personally see to it that the desires and requirements of our customers and users are optimally met every day with pioneering developments and solutions, highefficiency products, tailored solutions for special applications and for industry and extensive service offerings.

This is what we mean by “Pioneering for You.”





威乐始于1872年，总部位于德国多特蒙德，是全球领先的供热、空调和制冷用水泵及水泵系统制造商，威乐在全球拥有7000多名员工，60家生产和销售分公司。

威乐在中国历经近二十年的发展，销售网络覆盖到全国的重点省份和地区，雇员达到800多人，威乐中国以研发和推广适合中国用户需求的产品和解决方案为己任，其高效节能的水泵解决方案全面涵盖建筑楼宇、水务市场和工业领域。同时，秉承德国传统制造理念，威乐中国保持锐意进取、注重品质的态度，始终坚持节能减排理念，以最优的解决方案为客户节约采购成本，提升使用效率。2012年，威乐中国新生产基地落成并投入使用，将迈入全速发展的新时期。值得一提的是新工厂拥有完善和先进的测试台设备，测试水池深：12米；最大试验功率：2500kW；最大吊车额定载重：25吨。

每天我们都在矢志不渝地开拓创新，为我们的客户提供量身定制解决方案及服务。

这就是威乐的奋斗目标“Pioneering for You.”

Contents

AUTOMATIC PRESSURE BOOSTING/自动增压泵	4
MULTI-PURPOSE/多种用途	12
HOT WATER CIRCULATION/热水循环泵	22
SPECIAL LIQUID APPLICATION/特殊介质应用	32
DRAINAGE, SEWAGE, DRAIN LIFT/排水, 污水, 污水提升	35

By flow sensor/流量控制



PB-088EAH



PB-H091EAH



PB-H170EAH



PB-H401EAH



PB-S126EAH

Performance curve/性能曲线

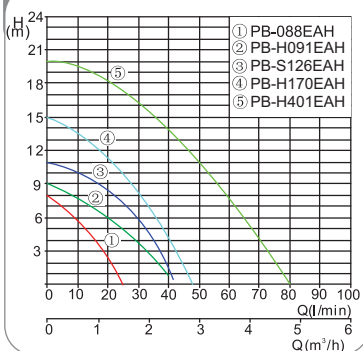

Centrifugal home booster/离心家用增压泵

PB-088EAH/H091EAH/H170EAH/H401EAH

Feature/特征:

- Flow Sensor/流量控制
- Centrifugal Impeller, Low Noise/离心叶轮, 低噪音
- Constant working pressure/运行压力稳定

Application/应用:

- Roof tank to tap water transfer/屋顶水箱向下供水
- Pressure boosting in household/家庭供水增压

Rust-proof centrifugal home booster/耐腐蚀的离心家用增压泵

PB-S126EAH

Feature/特征:

- Perfect rust-proof by Engineering plastic hydraulics/工程塑料水力部件, 彻底解决生锈问题
- Low noise level (below 50dB)/低噪音(50dB以下)
- Accurate automatic operation/自动开关灵敏
- High efficiency/高效率
- Compact and light/结构紧凑, 重量轻

Application/应用:

- Roof tank to tap water transfer/屋顶水箱向下供水
- Pressure boosting in household/家庭供水增压

Specification 详述

		PB-088EAH	PB-H091EAH	PB-H170EAH	PB-H401EAH	PB-S126EAH
Electrical connection 电气连接						
Power source 电源参数		1~220V/50Hz				
Input power P ₁ (W) 输入功率		90	110	290	550	230
Output power P ₂ (W) 输出功率		80	60	160	400	125
Applications 应用场合						
Approved fluids 输送介质		Clean water 清水				
Fluid temp (°C) 介质温度		0 ~ 60	0 ~ 100		0 ~ 80	
Per ormance data 性能参数						
Max head (m) 最大扬程		8	9	15	20	11
Max flow (l/min) 最大流量		25	40	45	75	42
Rated flow (l/min) 额定流量		13	17	22	40	25
Rated head (m) 额定扬程		5.5	6.5	10	15	7.5
Inlet size (mm) 进口尺寸		15	15	15	32	15
Outlet size (mm) 出口尺寸		15	15	15	32	15
Max pressure (bar) 最大承压		3.0	5.0	5.0	5.0	4.0
Protection class 防护等级		IP44	IP44	IP44	IP44	IP44
Weight (kg) 重量		3.5	3.5	7	12	5
Materials 材质						
Casing 泵体		Cast Iron 铸铁			Plastic 工程塑料	
Impeller 叶轮		Plastic 工程塑料				
Shaft 轴		Stainless Steel 不锈钢				
Mechanical seal 机械密封		Carbon & Ceramic 石墨&陶瓷				

5 AUTOMATIC PRESSURE BOOSTING /自动增压泵

By flow sensor & pressure switch/流量压力双控制



Centrifugal home booster with pressure tank/带压力罐的增压泵

PB-251SEAH/402SEAH

Feature/特征:

Flow Sensor & Pressure Switch/流量压力双控制
 3m suction is possible with foot valve/加底阀能实现3m吸程
 Constant working pressure/运行压力稳定

Application/应用:

Ground to tap water transfer/可实现地面向上增压供水
 Pressure boosting for water supply in household/家庭供水增压

Inverter pressure boosting pump/变频增压泵

PE-350EA

Feature/特征:

Energy-saving up to 20% with inverter technology/使用变频技术，节能高达20%
 Advanced auto-control with pressure sensor/结合内置压力传感器实现精准自控
 New material and coating technology application (FDA approved)/通过FDA认证的新材料及涂层技术
 Low noise, around 40dB/低噪音，大约为40dB

Application/应用:

Ground to tap water transfer/可实现地面向上增压供水
 Pressure boosting for water supply in household/家庭供水增压

Performance curve/性能曲线

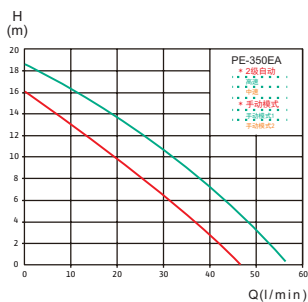
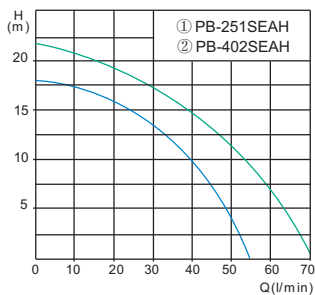

Specification 详述

		PB-251SEAH	PB-402SEAH	PE-350EA
Electrical connection 电气连接				
Power source 电源参数		1~220V/50Hz		
Input power P ₁ (W) 输入功率		370	500	380
Output power P ₂ (W) 输出功率		250	400	300
Applications 应用场合				
Approved fluids 输送介质		Clean water 清水		
Fluid temp (°C) 介质温度		0 ~ 60		0 ~ 35
Performance data 性能参数				
Total head (m) 全扬程		18	21	18
Max suction (m) 最大吸程		3	3	-
Max flow (l/min) 最大流量		65	70	55
Rated flow (l/min) 额定流量		35	50	-
Rated head (m) 额定扬程		12	10	-
Inlet size (mm) 进口尺寸		25	32	25
Outlet size (mm) 出口尺寸		25	32	25
On/Off (bar / l/min) 启停值		0.8/5	1.1 / 5	-
Max pressure (bar) 最大承压		5.0	5.0	4
Protection class 防护等级		IP44	IP44	IPX6
Weight (kg) 重量		9	10	5.5
Materials 材质				
Casing 泵体		Cast Iron 铸铁		Plastic 工程塑料
Impeller 叶轮		Plastic 工程塑料		
Shaft 轴		Stainless Steel 不锈钢		
Mechanical seal 机械密封		Carbon & Ceramic 石墨&陶瓷		

7 AUTOMATIC PRESSURE BOOSTING /自动增压泵

By inverter/变频控制



Horizontal multistage pump with inverter/变频多级泵

COR-1MHI 200/400/800/1600 Booster

Feature/特征:

Control by inverter/变频控制

Low Noise, low vibration/低噪音, 低震动

PLC & Inverter to avoid pump on/off excessively/PLC和变频技术相结合, 避免水泵频繁启停

With high-reliability due to ceramic sensor/陶瓷传感器, 可靠性高

Stop automatically at delay time/0流量延时停机

Stainless steel hydraulics/不锈钢水力部件

Easy operation, easy maintenance/易操作, 易维护

No water protector/内置缺水保护

Application/应用:

Various water supply application, sprinklers/各种不同水量需求的供水, 洒水领域

Small to medium-sized building/中小型建筑物供水增压

HVAC, condensate water, water-glycol mixture/暖通, 冷凝水, 水和乙二醇混合液

Performance curve/性能曲线

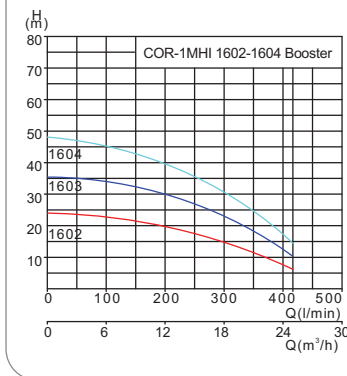
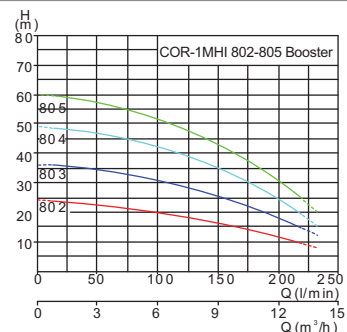
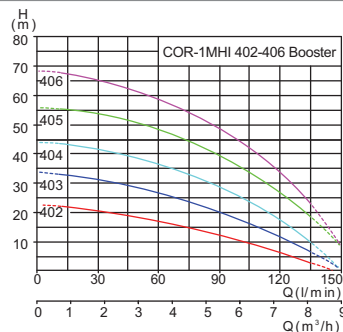
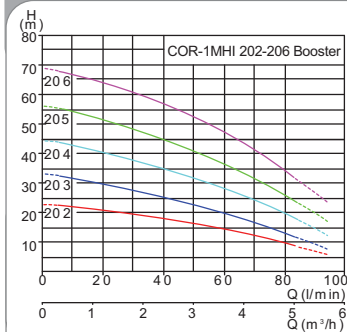

Specification 详述

	COR-1MHI 200 Booster	400	800	1600
Electrical connection 电气连接				
Power source 电源参数	1~220V/50Hz			
Applications 应用场合				
Approved fluids 输送介质	Clean water 清水			
Fluid temp (°C) 介质温度	-15 ~ +90			
Performance data 性能参数				
Max head (m) 最大扬程	69	65	59	48
Max flow (l/min) 最大流量	83	133	216	433
Max pressure (bar) 最大承压	10			
Protection class 防护等级	IP31			
Materials 材质				
Casing 泵体	Stainless Steel 不锈钢			
Impeller 叶轮	Stainless Steel 不锈钢			
Shaft 轴	Stainless Steel 不锈钢			
Mechanical seal 机械密封	Carbon & Ceramic 石墨&陶瓷			
Pressure Sensor 传感器	Ceramic 陶瓷			

Outline drawing/外形图

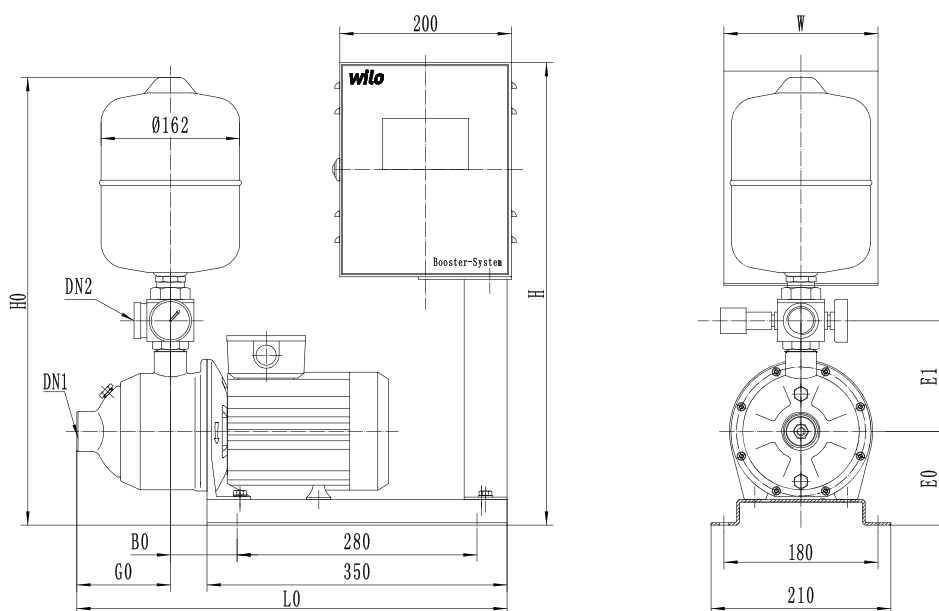

COR-1 MHIxxx/Booster	额定功率 Rating power (kW)	DN2	DN1	E0	E1	G0	B0	L0	H0	H	W	压力设定 Pressure setting (bar)
MHI 202	0.37	25	25	120	138	110	80	505	541	540	180	1.6
MHI 203	0.55	25	25	120	138	110	80	505	541	540	180	2.4
MHI 204	0.55	25	25	120	138	158	80	553	541	540	180	3.0
MHI 205	0.75	25	25	120	138	158	80	553	541	540	180	4.0
MHI 206	1.1	25	25	120	138	182	80	557	541	540	180	5.0
MHI 402	0.55	25	32	120	138	110	80	505	541	540	180	1.6
MHI 403	0.55	25	32	120	138	110	80	505	541	540	180	2.4
MHI 404	0.75	25	32	120	138	158	80	553	541	540	180	3.0
MHI 405	1.1	25	32	120	138	158	80	553	541	540	180	4.0
MHI 406	1.5	25	32	130	138	182	80	577	551	540	180	5.0
MHI 802	0.75	32	40	120	144	122	80	517	552	540	180	1.6
MHI 803	1.1	32	40	120	144	122	80	517	552	540	180	2.4
MHI 804	1.5	32	40	130	144	182	80	577	562	540	180	3.0
MHI 805	1.85	32	40	130	144	182	80	577	562	540	180	4.0
MHI 1602	1.5	40	50	120	154	138	84	537	562	540	180	1.6
MHI 1603	1.85	40	50	120	154	138	84	537	562	540	180	2.4
MHI 1604	2.5	40	50	130	154	183	84	582	572	590	210	3.0

By pressure switch/压力控制



PW-177EAH/178EAH



PW-084EAH/202EAH/406EAH



PW-753EAH



PW-1500EA



PU-750EAH



HMI-204EM/404EM

Pressure boosting pump with pressure tank/带压力罐的自动增压泵

PW-084EAH/202EAH/177EAH/178EAH/406EAH/753EAH/1500EA, PU-750EAH

Feature/特征:

Self-Priming/自吸泵

Automatic operation by pressure switch/通过压力开关自动运行

Application/应用:

Well/井水

Small to medium-sized building/中小型建筑供水增压

Multistage pump with pressure tank/带压力罐的多级泵

HMI204EM/404EM

Feature/特征:

Automatic operation by pressure switch/通过压力开关自动运行

Stainless Steel hydraulics/不锈钢水力部件

Liquid Temp up to 70°C/介质温度可达70°C

Application/应用:

Small to medium-sized building/中小型建筑供水增压

Specification 详述

	PW-084EAH	PW-202EAH	PW-177EAH	PW-178EAH	PW-406EAH	PW-753EAH	PW-1500EA	PU-750EAH	HMI-204EM	HMI-404EM	
Electrical connection 电气连接											
Power source 电源参数	1~220V/50Hz										
Input power P ₁ (W) 输入功率	160	240	290	290	500	1000	1800	1000	-	-	
Output power P ₂ (W) 输出功率	96	150	175	175	400	750	1500	750	550	750	
Applications 应用场合											
Approved fluids 输送介质	Clean water 清水										
Fluid temp (°C) 介质温度	0 ~ 40									0 ~ 70	
Performance data 性能参数											
Total head (m) 全扬程	30	32	30	30	35	44	58	20	43	42	
Max suction (m) 最大吸程	7	8	8	8	8	8	8	5	-	-	
Max flow (l/min) 最大流量	21	32	33	33	40	50	60	145	83	133	
Rated flow (l/min) 额定流量	16	25	18	18	28	16	45	115	50	83	
Rated suction (m) 额定吸程	3	6	6	3	6	6	6	5	-	-	
Rated total head (m) 额定全扬程	9	9	16	16	20	31	32	12	25	25	
Inlet size (mm) 进口尺寸	20	20	25	25	25	40	40	40	25	32	
Outlet size (mm) 出口尺寸	20	20	25	25	25	40	40	40	25	32	
On / Off (bar) 启停值	0.7/1.3	1.0/1.6	1.1/1.8	1.6/2.4	1.6/2.4	2.5/3.5	3.5/4.5	0.6/1.4	2.5/3.5	2.5/3.5	
Max pressure (bar) 最大承压	5.0	5.0	5.0	5.0	5.0	5.0	8.0	5.0	10.0	10.0	
Protection class 防护等级	IP44	IP44	IP44	IP44	IP44	IP44	IP44	IP44	IP54	IP54	
Weight (kg) 重量	10.5	11.3	8.7	8.7	17	26	47	35	20.5	22.1	
Materials 材质											
Casing 泵体	Cast Iron 铸铁								Stainless Steel 不锈钢		
Impeller 叶轮	Brass 黄铜								Stainless Steel 不锈钢		
Shaft 轴	Stainless Steel 不锈钢										
Mechanical seal 机械密封	Carbon & Ceramic 石墨&陶瓷										

Performance curve/性能曲线

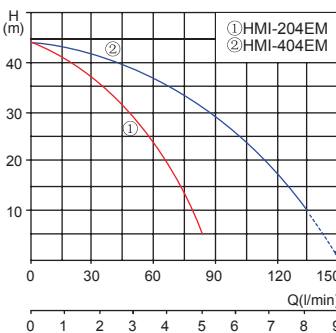
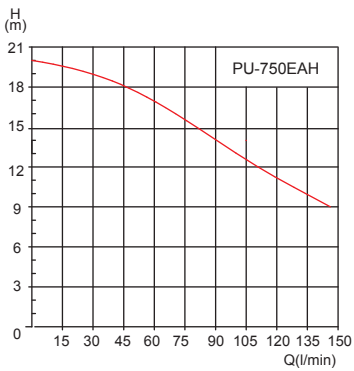
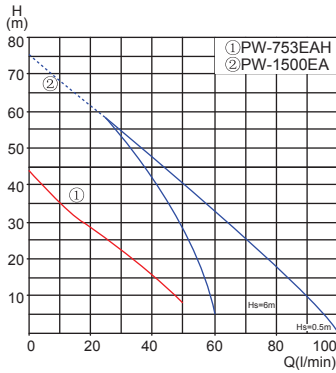
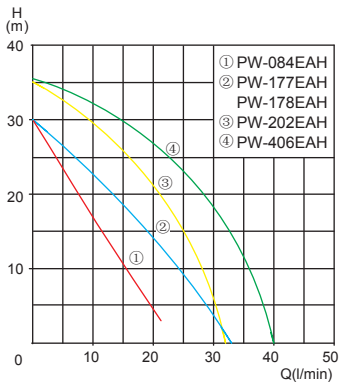

Outline drawing / 外形图

PW-177EAH/178EAH

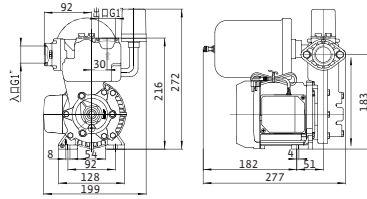

PW-084EAH

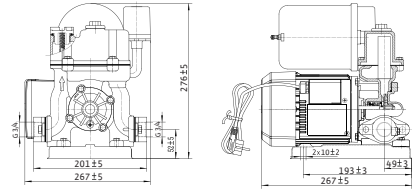

PW-753EAH

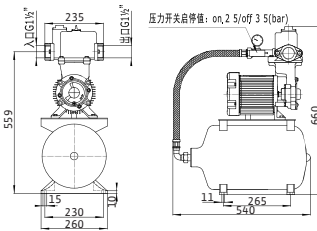

PW-1500EA

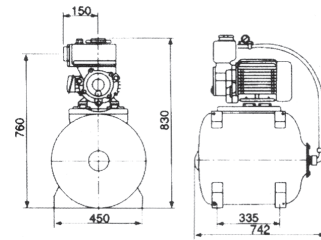

PU-750EAH

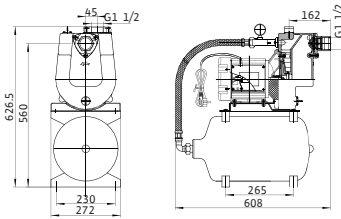

HMI-204EM/404EM

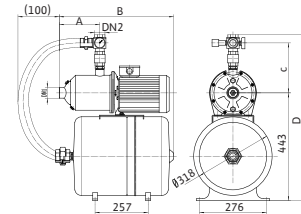

Model/型号	A	B	C	D	DN1	DN2
HMI-204EM	158	559	230	706	G1"	G1"
HMI-404EM	158	559	230	706	G1 1/4"	G1"

PW202EAH

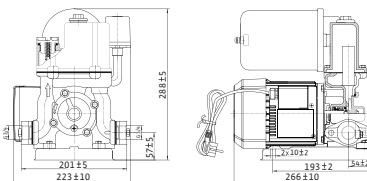

PW406EAH

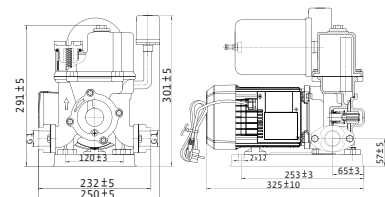

11 AUTOMATIC PRESSURE BOOSTING /自动增压泵

Smart automatic pressure boosting pump/ 智能自动增压泵



Smart automatic pressure boosting pump/ 智能自动增压泵

PW-S170/171EAH

Feature/特征:

High standard of corrosion protection thanks to cataphoretic coating/电泳涂层，优异的防腐蚀性

New appearance design, easy for identification/全新的外观设计，可识别性

IEC motor, meet the national Class2 energy efficiency requirements/IEC标准电机设计，满足国家二级能效，节能环保

Pressure and flow double control functions, working stable and reliable/流量压力双开关控制，工作稳定可靠

Delay start, ensure safety/延迟启动，保护人身安全

Low noise, comfortable customer experience/低噪音，客户体验更舒适

Self-priming/具有自吸功能

Outline drawing/外形图

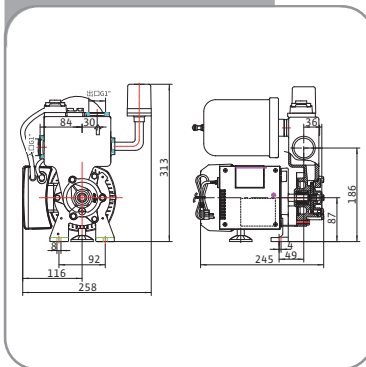

Application/应用:

Water in taking from Well/井水取水

Pressure boosting for small to medium-sized building/中小型建筑供水增压以及洒水器

Performance curve/性能曲线

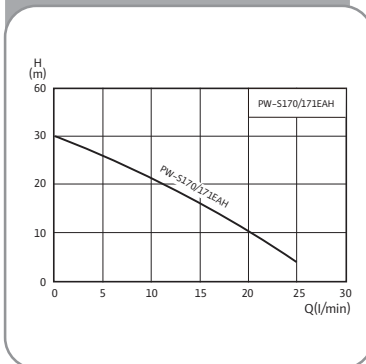

Specification 详述

	PW-S170EAH	PW-S171EAH
Electrical connection 电气连接		
Power source 电源参数	1~220V/50Hz	
Input power P ₁ (W) 输入功率	295	295
Output power P ₂ (W) 输出功率	170	170
Applications 应用场合		
Approved fluids 输送介质	Clean water 清水	
Fluid temp (°C) 介质温度	0 ~ 40	
Performance data 性能参数		
Max suction (m) 吸程	6/8	3/8
Total head (m) 全扬程	30	30
Max flow (l/min) 最大流量	25	25
Inlet size (mm) 进口尺寸	25	25
Outlet size (mm) 出口尺寸	25	25
Pump start(bar) 启动压力	1.1	1.6
Pump stop(L/min) 水泵停止	5	5
Max pressure (bar) 最大承压	5	5
Protection class 防护等级	IP44	IP44
Weight (kg) 重量	9.5	9.5
Materials 材质		
Casing 泵体	Cast Iron 铸铁	
Impeller 叶轮	Brass 铜	
Shaft 轴	Stainless Steel 不锈钢	
Mechanical seal 机械密封	Carbon & Ceramic 石墨&陶瓷	

For high pressure/高扬程



PW-177EH



PW-083EH/201EH/405EH/752EH



PW-750E/1500E/1500G



PU-401EH



PU-462E



PU-1500E/1500G

Pressure boosting pump without pressure tank/不带压力罐的增压泵

PW-083EH/201EH/177EH/405EH/752EH/750E/1500E/1500G

Feature/特征:

Easy maintenance, easy installation/易维护, 易安装
Self-priming/自吸泵

Application/应用:

Well/井水
Houses, general water supply by high pressure/家庭非自动高压供水增压

Centrifugal pumps for agricultural & industrial use/离心式农工业用泵

PU-401EH/462E/1500E/1500G

Feature/特征:

Self-priming/自吸
Big flow applications/大流量

Application/应用:

Agricultural use, industrial use/农业用, 工业用

Specification 详述

	PW-083EH	PW-201EH	PW-177EH	PW-405EH	PW-752EH	PW-750E	PW-1500E	PW-1500G	PU-401EH	PU-462E	PU-1500E	PU-1500G		
Electrical connection 电气连接	1~220V/50Hz								3~380/50Hz		1~220V/50Hz		3~380/50Hz	
Power source 电源参数														
Input power P ₁ (W) 输入功率	160	240	290	500	1000	1000	1800	1800	580	1000	1800	1800		
Output power P ₂ (W) 输出功率	96	150	175	400	750	750	1500	1500	400	400	1500	1500		
Applications 应用场合														
Approved fluids 输送介质	Clean water 清水													
Fluid temp (°C) 介质温度	0~40													
Performance data 性能参数														
Total head (m) 全扬程	30	32	30	35	51	55	58	58	13.5	14	21	21		
Max suction (m) 最大吸程	7	8	8	8	8	8	8	8	6	6	6	6		
Max flow (l/min) 最大流量	21	32	33	40	65	55	60	60	135	230	270	270		
Rated flow (l/min) 额定流量	16	25	18	28	30	30	40	40	110	200	240	240		
Rated suction (m) 额定吸程	3	6	6	6	6	6	6	6	3	3	3	3		
Rated total head (m) 额定全扬程	9	9	16	20	31	33	42	42	9	8	9	9		
Inlet size (mm) 进口尺寸	20	20	25	25	40	40	40	40	40	50	50	50		
Outlet size (mm) 出口尺寸	20	20	25	25	40	40	40	40	40	50	50	50		
Max pressure (bar) 最大承压	5.0	5.0	5.0	5.0	5.0	6.0	8.0	8.0	3.0	3.0	3.0	3.0		
Protection class 防护等级	IP44	IP44	IP44	IP44	IP44	IP44	IP44	IP44	IP44	IP44	IP44	IP44		
Weight (kg) 重量	9.5	10.3	7.5	16	20	23	34	34	16	30	40	40		
Materials 材质														
Casing 泵体	Cast Iron 铸铁													
Impeller 叶轮	Brass 黄铜													
Shaft 轴	Stainless Steel 不锈钢													
Mechanical seal 机械密封	Carbon & Ceramic 石墨&陶瓷													

Performance curve/性能曲线

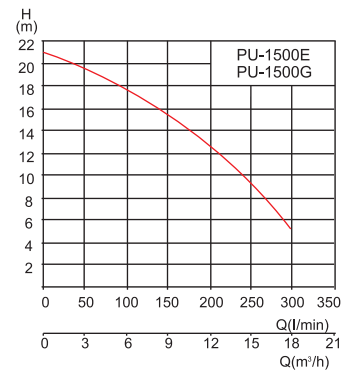
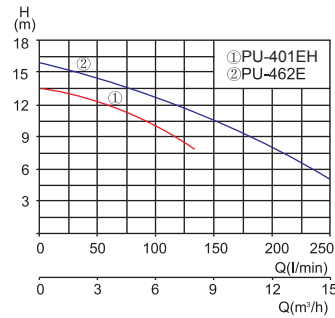
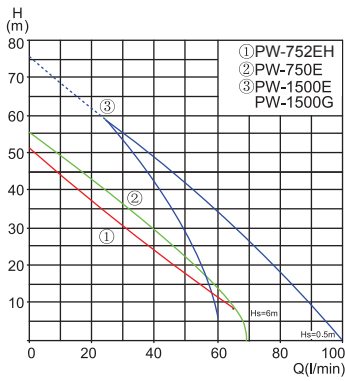
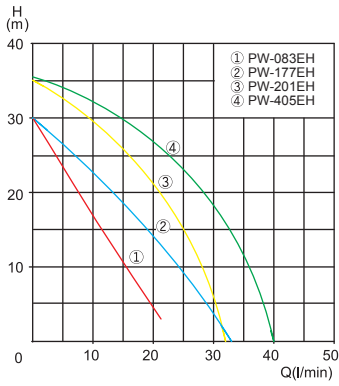

Outline drawing/外形图

PW-177EH

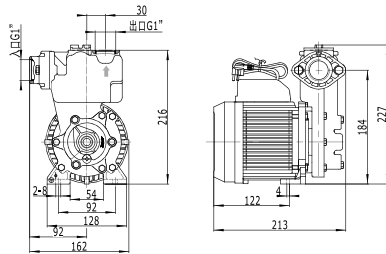

PW-083EH/201EH

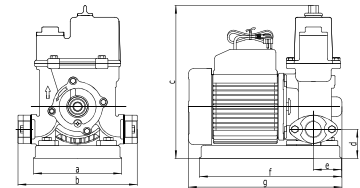

Model/型号	a	b	c	d	e	f	g
PW-083EH	-	201	244	52	49	-	267
PW-201EH	-	201	277	52	54	-	266

PW-752EH/750E

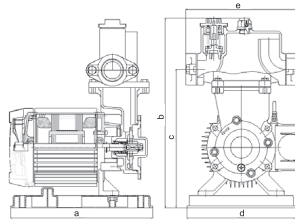

Model/型号	a	b	c	d	e
PW-752EH	305	396	291	236	235
PW-750E	300	396	290	230	235

PW405EH

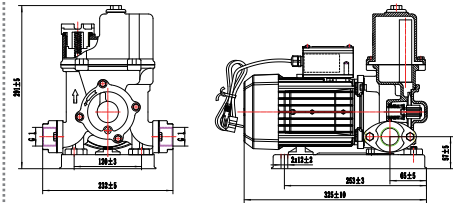

PU-401EH

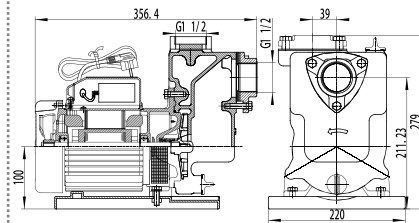

PU-462E

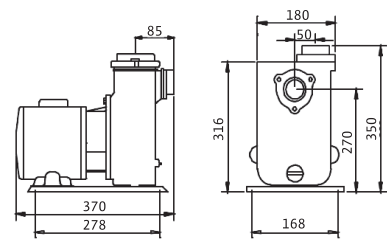

PU-1500E/1500G

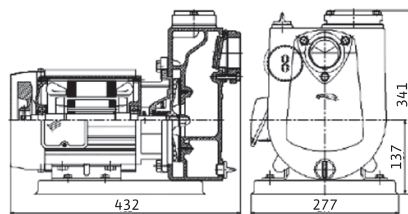

PW-1500E/1500G

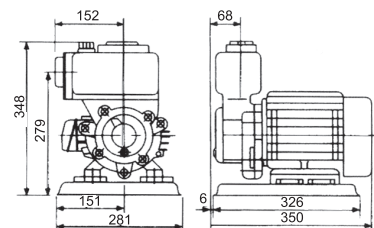

For various machinery/各种机器配套



PWN-241EH



PWN-163EH



PUN-201EH/402EH/403EH/601EH



PUN-750EH/751EH



PUN-1100E

Peripheral pump/涡旋泵

PWN-241EH/163EH

Feature/特征:

Long life/使用寿命长
Low flow at high head/小流量，高扬程

Application/应用:

For various machinery/各种机器配套
Pressure boosting in household/家庭用水增压

Centrifugal pump/离心泵

PUN-201EH/402EH/403EH/601EH/750EH/751EH/1100E

Feature/特征:

Low flow at high head/小流量，高扬程
Compact design/紧密结构设计

Application/应用:

For various machinery/各种机器配套
General water supply for house, garden/家庭，花园供水
Small HVAC circulation system/小型暖通空调循环系统

Specification 详述

		PWN-241EH	PWN-163EH	PUN-201EH	PUN-402EH	PUN-403EH	PUN-601EH	PUN-750EH	PUN-751EH	PUN-1100E
Electrical connection 电气连接										
Power source 电源参数		1~220V/50Hz								
Input power P ₁ (W) 输入功率		240	280	320	720	660	880	1100	1250	1500
Output power P ₂ (W) 输出功率		150	160	200	400	400	600	750	750	1100
Applications 应用场合										
	输送介质	Clean water 清水								
Fluid temp (°C) 介质温度		0~40			0~90				0~40	
Performance data 性能参数										
Max head (m) 最大扬程		39	30	15	21	21	25	25	30	23
Max flow (l/min) 最大流量		19	40	80	100	90	115	200	125	360
Rated flow (l/min) 额定流量		10	20	38	50	50	50	110	80	220
Rated head (m) 额定扬程		15	15	10	15	15	20	17.5	20	15
Inlet size (mm) 进口尺寸		15	25	25	32	25	25	32	32	50
Outlet size (mm) 出口尺寸		15	25	25	32	25	25	32	32	50
Max pressure (bar) 最大承压		5.0	5.0	5.0	5.0	5.0	5.0	4.0	4.0	4.0
Protection class 防护等级		IP44	IP44	IP44	IP44	IP44	IP44	IP44	IP44	IP44
Weight (kg) 重量		6.7	6	5	11	11	12.6	13	13	21
Materials 材质										
Casing 泵体		Cast Iron 铸铁								
Impeller 叶轮		Brass 黄铜			Plastic 工程塑料					
Shaft 轴		Stainless Steel 不锈钢								
Mechanical seal 机械密封		Carbon & Ceramic 石墨&陶瓷								

Stainless steel self-priming/不锈钢自吸泵



Self-priming booster pump/自吸增压泵

MC3.../6.../HiMulti 3 Series

Feature/特征:

Self-priming/自吸

HiMulti 3 plastic hydraulics with drinking certification / HiMulti 3 水力部件为高分子材料，符合饮用水认证

High pressure by multi-stage impeller/多级叶轮，高扬程

Application/应用:

Water supply and boosting/供水和增压

Small and medium-sized construction water supply booster/中小型建筑供水增压

Electronic switch/电子开关

Fluid Cotrol

Feature/特征:

Automatic Function/自动启停

-Min start pressure/最小启动压力: 1.5 to 2.7 bar可调

-Stop flow/停止流量: 1 to 1.5 l/min

Anti Hammering system/防水锤

Against leakages/缓解微渗漏

-Water Reserve /储存水量: 3 to 1.5 bar 45 ml
4 to 1.5 bar 65 ml

Dry running protection/干转保护

Application/应用:

Water supply and boosting/供水和增压

Small and medium-sized construction water supply booster/中小型建筑供水增压

Performance curve/性能曲线

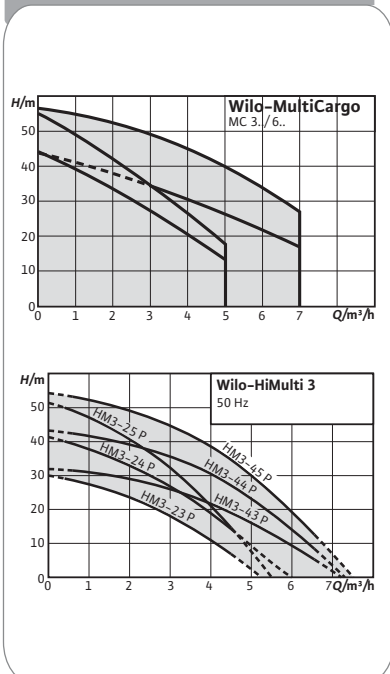

Specification 详述

	MC3 ...	MC6 ...	HM3-20P	HM3-40P	Fluid Cotrol
Electrical connection 电气连接					
Power source 电源参数	3~400V/50Hz		1~230V/50Hz		1~220V(110V) /50-60Hz
Applications 应用场合					
Approved fluids 输送介质	Clean water 清水				
Fluid temp (°C) 介质温度	5~35		0~40		0~60
Performance data 性能参数					
Max head (m) 最大扬程	55	57	50	53	-
Max flow (m³/h) 最大流量	5	7	4.5	6.5	10
Max suction (m) 最大吸程	8		8		-
Inlet size(mm) 进口尺寸	25		25		25
Outlet size(mm) 出口尺寸	25		25		25
Max pressure (bar) 最大承压	8		8		10
Protectinn class 防护等级	IP54		IPx4		IP65
Materials 材质					
Casing 泵体	Stainless Steel 不锈钢		Plastic 高分子材料		-
Impeller 叶轮	Plastic 工程塑料		Plastic 高分子材料		-
Shaft 轴	Stainless Steel 不锈钢				
Mechanical seal 机械密封	Carbon & Ceramic 石墨&陶瓷				

17 MULTI-PURPOSE / 多种用途

Outline drawing/外形图

MC Series

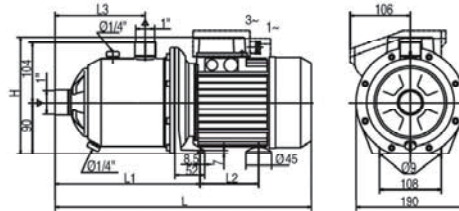

型号 Model	输出功率 Output Power P2 kW	输入功率 Input Power P1 kW	输入电流 (Input Electricity)A		尺寸 (Measurement)mm					净重 Gross weight kg
			3~230V	3~400V	H	L	L1	L2	L3	
MC304-DM	0.55	0.83	3.3	1.9	190	418	253	94	157.5	10.8
MC305N-DM	0.75	1.08	3.2	1.85	219	481	277	110	181.5	14.5
MC604N-DM	1.1	1.37	4.3	2.5	219	457	253	110	157.5	15.3
MC605N-DM	1.1	1.37	4.3	2.5	219	481	277	110	181.5	15.9

HiMulti 3

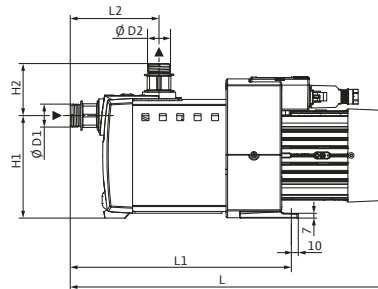

型号 Model	输出功率 Output Power P2 kW	输入功率 Input Power P1 kW	输入电流 (Input Electricity)A	尺寸 (Measurement)mm						净重 Gross weight kg	
				1~230V	H1	H2	L	L1	L2		$\phi D1$
HiMulti 3-23 P	400	640	3	147	34	353	228	87	1"	1"	9.6
HiMulti 3-24 P	400	640	3	147	34	396	252	87	1"	1"	11.2
HiMulti 3-25 P	500	730	3.3	147	34	414	276	87	1"	1"	13.3
HiMulti 3-43 P	400	640	3	147	34	372	128	87	1"	1"	10.9
HiMulti 3-44 P	600	840	3.8	147	34	389	251	87	1"	1"	13.0
HiMulti 3-45 P	800	1060	4.6	147	34	441	276	87	1"	1"	14.9

Fluid Cotrol

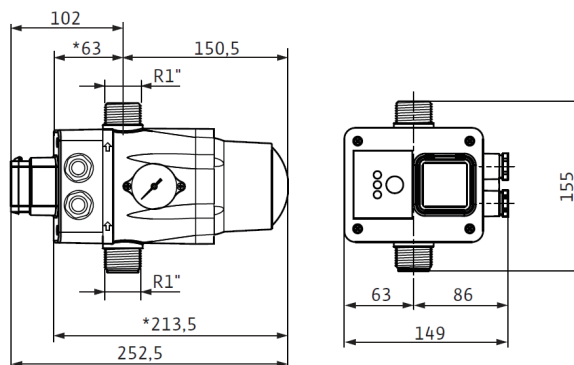

Multi-stage impeller/多级叶轮



Horizontal multistage stainless steel pump/卧式多级不锈钢泵

MHI200/400/800/1600 Series, MHIL200/400/800 Series

Feature/特征:

- Stainless steel materials/不锈钢材质
- High pressure by multi-stage impeller/多级叶轮，高扬程
- CQC certification/获得中国节能认证证书

Application/应用:

- Water supply and pressure boosting/供水和增压
- Hot water circulation and heating system/热水循环和采暖系统
- Air-conditioning systems/空调系统
- Industrial circulation systems/工业循环系统
- Washing and sprinkling systems/清洗及喷洒灌溉系统
- For various machinery/各种机器配套

Performance curve/性能曲线

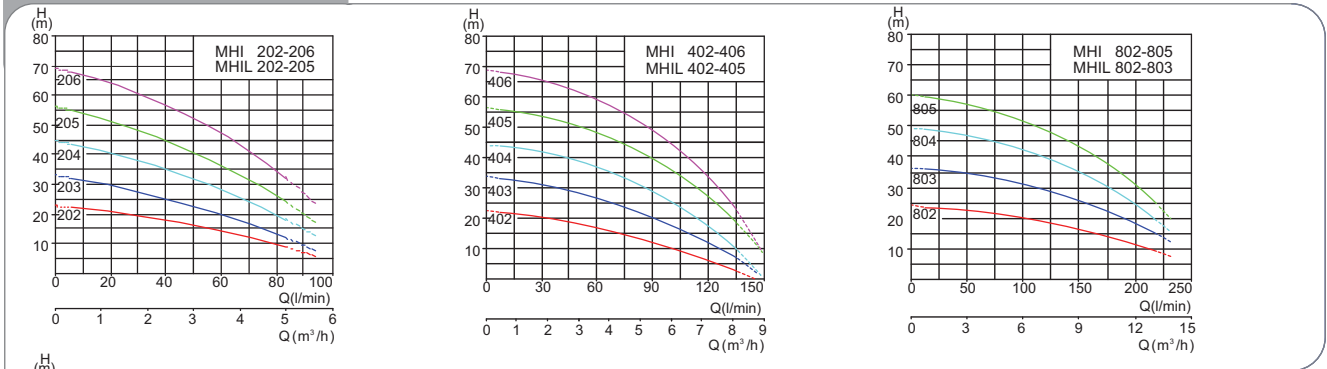

Specification 详述

	MHI 200	MHI 400	MHI 800	MHI 1600	MHIL 200	MHIL 400	MHIL 800
Electrical connection 电气连接							
Power source 电源参数	1~220V/50Hz, 3~380(220) V/50Hz						
Applications 应用场合							
Approved fluids 输送介质	Clean water 清水						
Fluid temp (°C) 介质温度	-15 ~ +110				-15 ~ +90		
Performance data 性能参数							
Max head (m) 最大扬程	69	65	59	48	69	65	59
Max flow (l/min) 最大流量	83	133	216	433	83	133	216
Max pressure (bar) 最大承压	10						
Protection class 防护等级	IP54						
Materials 材质							
Casing 泵体	Stainless Steel 不锈钢				Cast Iron 铸铁		
Impeller 叶轮	Stainless Steel 不锈钢						
Shaft 轴	Stainless Steel 不锈钢						
Mechanical seal 机械密封	Carbon & Silicon Carbide 石墨&碳化硅						

Outline drawing/外形图

MHI Series

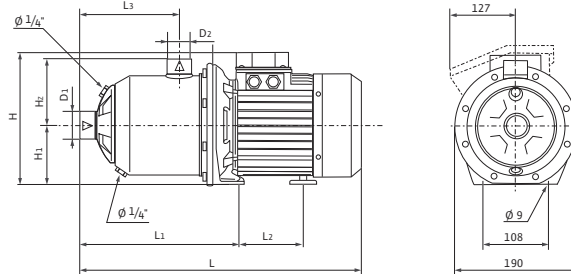

型号 (Model)	额定功率 (Rating Power) KW	额定电流(Rating Electricity) In			ØD1	ØD2	L		H		重量(Weight)	
		1-220V	3-220V	3-380V			1-220V	3-380V	1-220V	3-380V	1-220V	3-380V
		[RP]					[mm]				[kg]	
MHI202	0.37	2.58	1.89	1.09	1"	1"	378	378	200	203	8.9	8.9
MHI203	0.55	3.46	2.56	1.48	1"	1"	397	397	200	203	8.9	8.9
MHI204	0.55	3.46	2.56	1.48	1"	1"	445	445	200	203	8.9	8.9
MHI205	0.75	4.85	3.01	1.74	1"	1"	436	436	208	211	12.2	11.3
MHI206	1.10	6.55	4.40	2.54	1"	1"	482	476	215	218	13.7	12.9
MHI402	0.55	3.46	2.56	1.48	1 1/4"	1"	397	397	200	203	8.9	8.9
MHI403	0.55	3.46	2.56	1.48	1 1/4"	1"	397	397	200	203	8.9	8.9
MHI404	0.75	4.85	3.01	1.74	1 1/4"	1"	436	436	208	211	12.2	11.3
MHI405	1.10	6.55	4.40	2.54	1 1/4"	1"	458	452	215	218	13.4	12.5
MHI406	1.50	9.15	6.10	3.52	1 1/4"	1"	525	476	229	218	15.7	14.2
MHI802	0.75	4.85	3.01	1.74	1 1/2"	1 1/4"	400	400	208	211	11.5	10.6
MHI803	1.10	6.55	4.40	2.54	1 1/2"	1 1/4"	422	416	215	218	13.5	12.2
MHI804	1.50	9.15	6.10	3.52	1 1/2"	1 1/4"	525	476	229	218	15.6	14.8
MHI805	1.85	-	6.95	4.01	1 1/2"	1 1/4"	-	519	-	240	-	16.2
MHI1602	1.50	-	6.10	3.52	2"	1 1/2"	-	435	-	218	-	14.1
MHI1603	1.85	-	6.95	4.01	2"	1 1/2"	-	478	-	240	-	15.7
MHI1604	2.20	-	9.70	5.60	2"	1 1/2"	-	523	-	240	-	17.5

MHIL Series

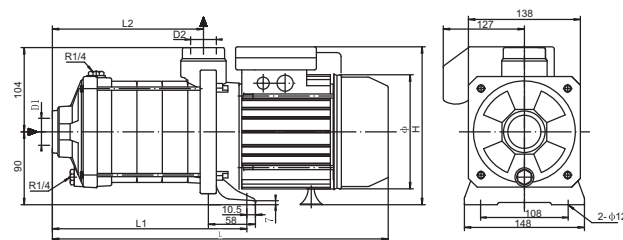

型号 (Model)	额定功率 (Rating Power) KW	额定电流(Rating Electricity) In			ØD1	ØD2	L		H		重量(Weight)	
		1-220V	3-220V	3-380V			1-220V	3-380V	1-220V	3-380V	1-220V	3-380V
		[RP]					[mm]				[kg]	
MHIL202	0.37	2.58	1.89	1.09	1"	1"	336	336	200	203	12.9	12.9
MHIL203	0.55	3.46	2.56	1.48	1"	1"	380	380	200	203	12.9	12.9
MHIL204	0.55	3.46	2.56	1.48	1"	1"	404	404	200	203	12.9	12.9
MHIL205	0.75	4.85	3.01	1.74	1"	1"	420	420	208	211	16.2	15.3
MHIL206	1.10	6.55	4.40	2.54	1"	1"	465	460	215	218	17.7	16.9
MHIL402	0.55	3.46	2.56	1.48	1 1/4"	1"	356	356	200	203	12.9	12.9
MHIL403	0.55	3.46	2.56	1.48	1 1/4"	1"	380	380	200	203	12.9	12.9
MHIL404	0.75	4.85	3.01	1.74	1 1/4"	1"	395	395	208	211	16.2	15.3
MHIL405	1.10	6.55	4.40	2.54	1 1/4"	1"	441	436	215	218	17.4	16.5
MHIL406	1.50	9.15	6.10	3.52	1 1/4"	1"	508	460	229	218	19.7	18.2
MHIL802	0.75	4.85	3.01	1.74	1 1/2"	1 1/4"	360	354	208	211	15.5	14.6
MHIL803	1.10	6.55	4.40	2.54	1 1/2"	1 1/4"	413	401	215	218	17.5	16.2
MHIL804	1.50	9.15	6.10	3.52	1 1/2"	1 1/4"	485	431	229	218	19.6	18.8
MHIL805	1.85	-	6.95	4.01	1 1/2"	1 1/4"	-	509	-	240	-	20.2

Multi-stage impeller/多级叶轮



MVI Series

Vertical multistage stainless steel pump/立式多级不锈钢泵

MVI200/400/800/1600 Series

Feature/特征:

- Stainless steel materials/不锈钢材质
- High pressure by multi-stage impeller/多级叶轮，高扬程
- CQC certification/获得中国节能认证证书

Application/应用:

- Water supply and pressure boosting/供水和增压
- Hot water circulation and heating system/热水循环和采暖系统
- Air-conditioning systems/空调系统
- Industrial circulation systems/工业循环系统
- Washing and sprinkling systems/清洗及喷洒灌溉系统
- For various machinery/各种机器配套

Performance curve/性能曲线

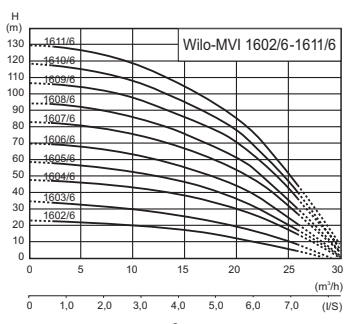
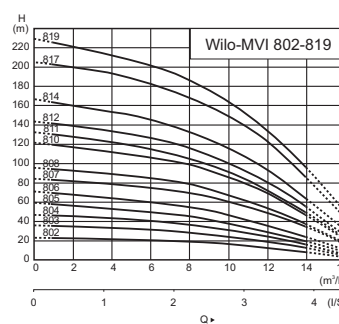
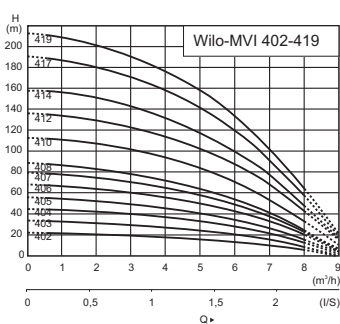
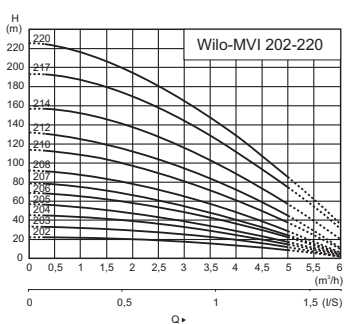

Specification 详述

	MVI 200	MVI 400	MVI 800	MVI 1600/6
Electrical connection 电气连接				
Power source 电源参数	3~380 (220) V/50Hz			
Applications 应用场合				
Approved fluids 输送介质	Clean water 清水			
Fluid temp (°C) 介质温度	-15 ~ +120			
Performance data 性能参数				
Max head (m) 最大扬程	230	210	230	130
Max flow (m³/h) 最大流量	5	8	14	26
Max pressure (bar) 最大承压	16/25			
Protection class 防护等级	IP55			
Materials 材质				
Casing 泵体	Stainless Steel 不锈钢			
Impeller 叶轮	Stainless Steel 不锈钢			
Shaft 轴	Stainless Steel 不锈钢			
M/Seal 机封	Carbon & Silicon Carbide, Tungsten Carbide 石墨 & 碳化硅, 碳化钨			

Outline drawing/外形图

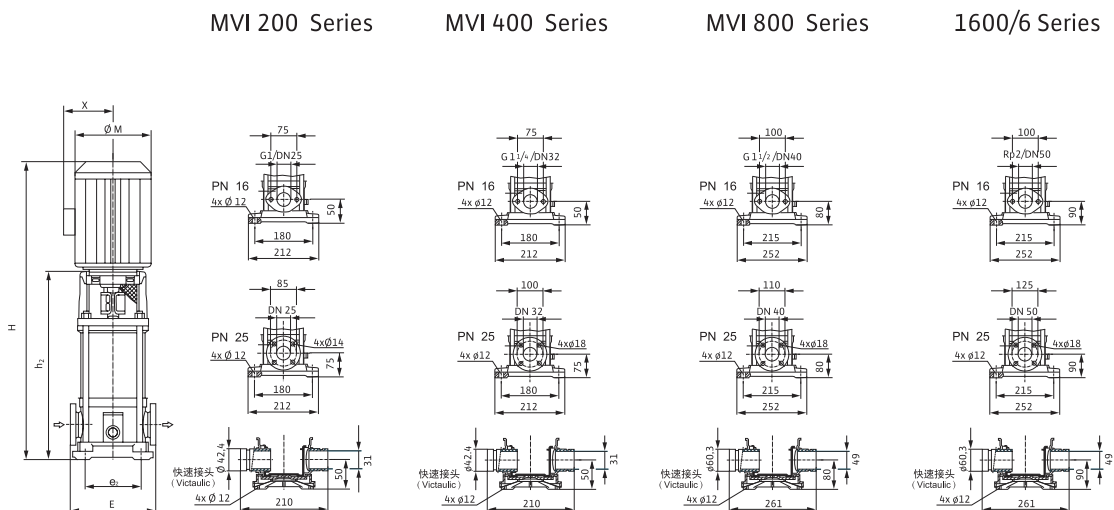

型号 (Model)	额定功率 (Rating Power)kW	额定电流(Rating Electricity) I _N		PN16型						重量 (Weight) kg
		3~220V	3~380V	E	e ₂	H	h ₂	Ø M	X	
MVI202	0.37	1.71	0.99	160	100	522	296.5	140	130	18.0
MVI203	0.55	2.42	1.40	160	100	522	296.5	140	130	19.0
MVI204	0.75	3.07	1.77	160	100	576	330.5	155	145	22.0
MVI205	0.75	3.07	1.77	160	100	600	354.5	155	145	23.0
MVI206	1.1	4.33	2.53	160	100	624	378.5	155	145	27.0
MVI207	1.1	4.33	2.53	160	100	648	402.5	155	145	29.0
MVI208	1.5	5.79	3.34	160	100	741	436.5	175	157	34.0
MVI210	1.5	5.79	3.34	160	100	789	484.5	175	157	36.0
MVI212	2.2	8.19	4.73	160	100	837	532.5	175	157	38.0
MVI402	0.55	2.42	1.40	160	100	522	296.5	140	130	19.0
MVI403	0.75	3.07	1.77	160	100	522	306.5	155	145	20.0
MVI404	1.1	4.33	2.53	160	100	576	330.5	155	145	23.0
MVI405	1.1	4.33	2.53	160	100	600	354.5	155	145	24.0
MVI406	1.5	5.79	3.34	160	100	693	388.5	175	157	29.0
MVI407	1.5	5.79	3.34	160	100	717	412.5	175	157	30.0
MVI408	2.2	8.19	4.73	160	100	741	436.5	175	157	34.0
MVI410	2.2	8.19	4.73	160	100	789	484.5	175	157	35.0
MVI412	3.0	10.72	6.19	160	100	855	542.5	196	155	43.0
MVI802	0.75	3.07	1.77	200	130	579	334	155	145	23.0
MVI803	1.1	4.33	2.53	200	130	609	364	155	145	26.0
MVI804	1.5	5.79	3.34	200	130	708	404	175	157	31.0
MVI805	2.2	8.19	4.73	200	130	738	434	175	157	34.0
MVI806	2.2	8.19	4.73	200	130	768	464	175	157	35.0
MVI807	3.0	10.72	6.19	200	130	816	504	196	155	43.0
MVI808	3.0	10.72	6.19	200	130	846	534	196	155	44.0
MVI810	4.0	-	8.05	200	130	927	593	220	174	51.0
MVI811	4.0	-	8.05	200	130	988	654	220	174	52.0
MVI812	5.5	-	10.9	200	130	1027	654	220	174	57.0
MVI1602/6	1.5	5.79	3.34	200	130	673	368.5	175	157	29.0
MVI1603/6	2.2	8.19	4.73	200	130	750	445.5	175	157	34.0
MVI1604/6	3.0	10.72	6.19	200	130	768	455.5	196	155	41.0
MVI1605/6	4.0	-	8.05	200	130	866	531.5	220	174	50.0
MVI1606/6	4.0	-	8.05	200	130	866	531.5	220	174	51.0
MVI1607/6	5.5	-	10.9	200	130	981	607.5	220	174	58.0
MVI1608/6	5.5	-	10.9	200	130	981	607.5	220	174	59.0
MVI1609/6	7.5	-	14.5	200	130	1085	703	300	193	78.0
MVI1610/6	7.5	-	14.5	200	130	1085	703	300	193	79.0
MVI1611/6	7.5	-	14.5	200	130	1161	779	300	193	81.0

Dry motor pump/干转子泵



PH-043EH/044EH



PH-045E



PH-102EH/150EH/256EH/257EH



PH-255EH



PH-750EH/751EH



PH-751QH/1501QH/2201QH

Small inline pump/小型管道泵

PH-043EH/044EH/045E/102EH/150EH/256EH/257EH/255EH/750EH/751EH/751QH/1501QH/2201QH

Feature/特征:

- In-line, easy installation/管道式安装, 连接方便
- Light and excellent design/重量轻, 优秀设计
- Long life/使用寿命长

Application/应用:

- Hot water circulation and heating system/热水循环和采暖系统
- Air-conditioning systems/空调系统
- Industrial circulation systems/工业循环系统
- General pressure boosting in household/家庭用水增压

Specification 详述

	PH-043EH	PH-044EH	PH-045E	PH-102EH	PH-150EH	PH-256EH	PH-257EH	PH-255EH	PH-750EH	PH-751EH	PH-751QH	PH-1501QH	PH-2201QH
Electrical connection 电气连接													
Power source 电源参数	1~220V/50Hz										3~380V/50Hz		
Input power P ₁ (W) 输入功率	90	90	90	150	220	450	450	330	900	1050	900	1750	2800
Output power P ₂ (W) 输出功率	40	40	40	100	150	250	250	250	750	750	750	1500	2200
Applications 应用场合													
Approved fluids 输送介质	Clean water 清水												
Fluid temp (°C) 介质温度	100												
Performance data 性能参数													
Max head (m) 最大扬程	3.5	3.5	3.5	5	5	7.5	7.5	15	16	20	20	25	30
Max flow (l/min) 最大流量	60	60	60	130	250	290	290	100	310	300	300	417	467
Rated flow (l/min) 额定流量	35	35	28	85	185	225	225	50	180	130	130	266	308
Rated head (m) 额定扬程	2.5	2.5	2.5	3	3	4	4	10	10	16	16	15	20
Inlet size (mm) 进口尺寸	25	32	25	40	50	65	50	40	80	50	50	50	50
Outlet size (mm) 出口尺寸	25	32	25	40	50	65	50	40	80	50	50	50	50
Max pressure (bar) 最大承压	5	5	2.0	5.0	5.0	5.0	5.0	5.0	5.0	5.0	5.0	5.0	5.0
Protection class 防护等级	IP44	IP44	IP22	IP44	IP44	IP44	IP44	IP44	IP44	IP44	IP55	IP55	IP55
Weight (kg) 重量	3.7	3.7	4	8.5	11	15	15	9	20	20	20	32	34
Materials 材质													
Casing 泵体	Cast Iron 铸铁												
Impeller 叶轮	Plastic 工程塑料						Brass/Plastic 黄铜/塑料						Cast Iron 铸铁
Shaft 轴	Stainless Steel 不锈钢												
Mechanical seal 机械密封	Carbon & Ceramic 石墨&陶瓷												

Performance curve/性能曲线

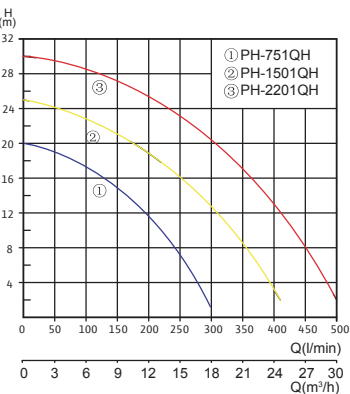
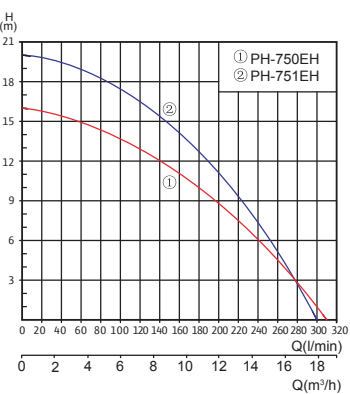
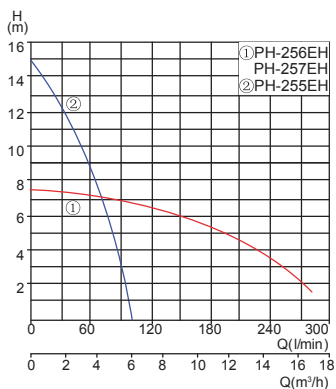
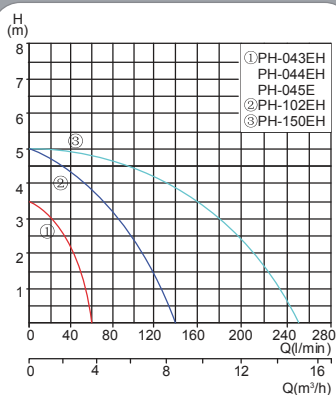

Outline drawing/外形图

PH-043EH/044EH

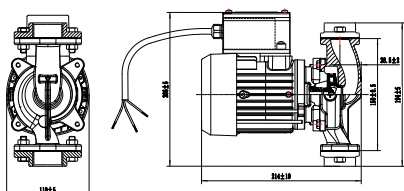

PH-045E

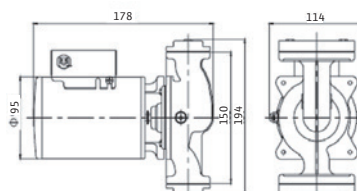

PH-102EH/150EH

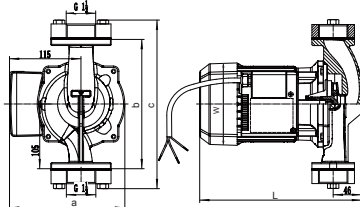

型号(Model)	L	W	a	b	c
PH-102EH	263	134	187	210	274
PH-150EH	298	134	193	260	311

PH-256EH/257EH

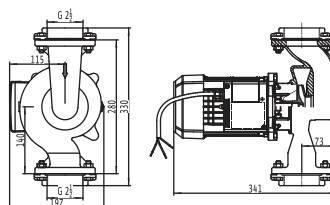

PH-255EH

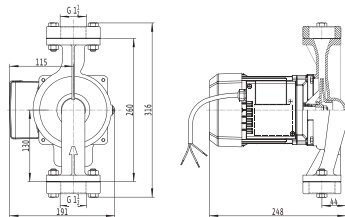

PH-750EH/751EH

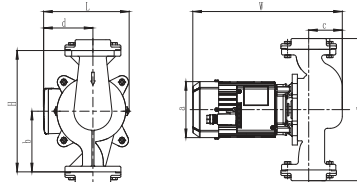

型号(Model)	W	L	H	S	a	b	c	d
PH-750EH/751EH	347	197	280	330	∅130	140	78	114

PH-751QH

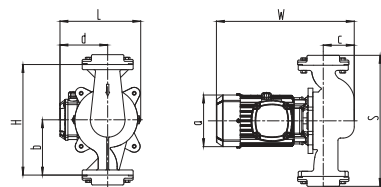

型号(Model)	W	L	H	S	a	b	c	d
PH-751QH	347	204	280	330	∅130	140	78	121

PH-1501QH/2201QH

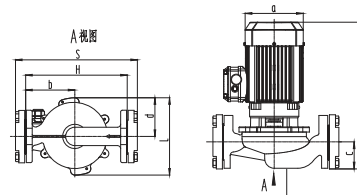

型号(Model)	W	L	H	S	a	b	c	d
PH-1501QH/PH-2201QH	434	268	310	372	∅172	160	78	150

Dry motor pump/干转子泵



HiPH 3 Series

Small inline pump/小型管道泵

HiPH 3-050EH/051EH/120EH/300EH/600EH/1100EH/1100QH

Feature/特征:

New industrial aesthetics design/全新工业美学设计
 New hydraulic design, higher efficiency/全新水力设计，更高整泵效率
 IEC motor, lower noise/IEC电机，噪音更低

Application/应用:

Hot water circulation and heating system/热水循环和采暖系统
 Air energy circulation system/空气能循环系统
 Solar thermal circulation system/太阳能循环系统
 Industrial circulation system/工业循环系统

Performance curve/性能曲线

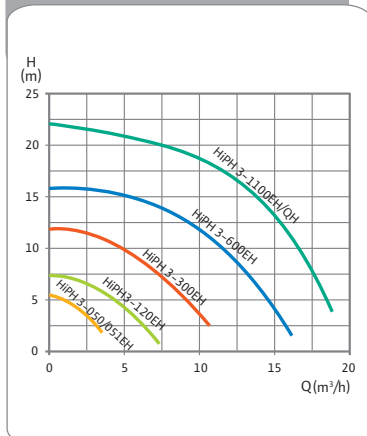

Specification 详述

	HiPH3-050EH	HiPH3-051EH	HiPH3-120EH	HiPH3-300EH	HiPH3-600EH	HiPH3-1100EH	HiPH3-1100QH
Electrical connection 电气连接							
Power source 电源参数	1~220V/50Hz						3~380V/50Hz
Applications 应用场合							
Approved fluids 输送介质	Clean water 清水						
Fluid temp (°C) 介质温度	0 ~ 100						
Performance data 性能参数							
Max head (m) 最大扬程	5.5	5.5	7.3	11.8	15.5	22	22
Max flow (m³/h) 最大流量	3.5	3.5	7.3	10.6	16	19	19
Rated flow (m³/h) 额定流量	2.4	2.4	4.6	6	9.6	11.5	11.5
Rated head (m) 额定扬程	3.5	3.5	4.2	9	12.4	17	17
Inlet size (mm) 进口尺寸	25	32	40	40	50	50	50
Outlet size (mm) 出口尺寸	25	32	40	40	50	50	50
Max pressure (bar) 最大承压	5	5	5	5	5	5	5
Protection class 防护等级	IP44	IP44	IP44	IP44	IP44	IP44	IP44
Weight (kg) 重量	5	5	7.8	10.2	21	24	24
Materials 材质							
Casing 泵体	Cast Iron 铸铁						
Impeller 叶轮	Plastic 工程塑料						
Shaft 轴	Stainless Steel 不锈钢						
Mechanical seal 机械密封	Carbon & Ceramic 石墨&陶瓷						

Outline drawing/外形图

HiPH 3 Series

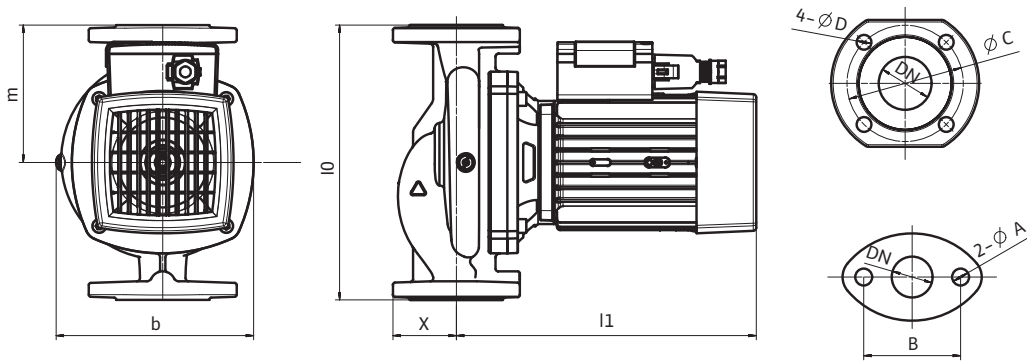

Wilo-HiPH 3	P_{1BEP} / P_{1MAX}	P_{2BEP} / P_{2MAX}	外形尺寸					Flange dimensions 法兰尺寸				
	额定/最大 输入功率	额定/最大 输出功率	b	l0	l1	m	x	DN	A	B	C	D
	[W]		[mm]									
HiPH 3-050EH	80/85	43/50	105	150	230	100	35	25	10	65	-	-
HiPH 3-051EH	80/85	43/50	105	150	230	100	35	32	10	65	-	-
HiPH 3-120EH	171/185	100/120	128	180	235	100	50	40	12	72	-	-
HiPH 3-300EH	340/400	243/300	145	180	270	105	46	40	12	72	-	-
HiPH 3-600EH	730/810	530/600	230	260	283	115	60	50	-	-	110	14
HiPH 3-1100EH	1100/1350	910/1100	230	260	300	115	60	50	-	-	110	14
HiPH 3-1100QH	1100/1350	910/1100	230	260	300	115	60	50	-	-	110	14

Dry motor pump/干转子泵



IPL Series

Standard inline pump/标准管道泵

IPL Series

Feature/特征:

In-line, easy installation/管道式安装, 连接方便
 Light and excellent design/重量轻, 优秀设计
 Long life/使用寿命长

Application/应用:

Hot water circulation and heating system/热水循环和采暖系统
 Air-conditioning systems/空调系统
 Industrial circulation systems/工业循环系统
 General pressure boosting in household/家庭用水增压

Performance curve/性能曲线

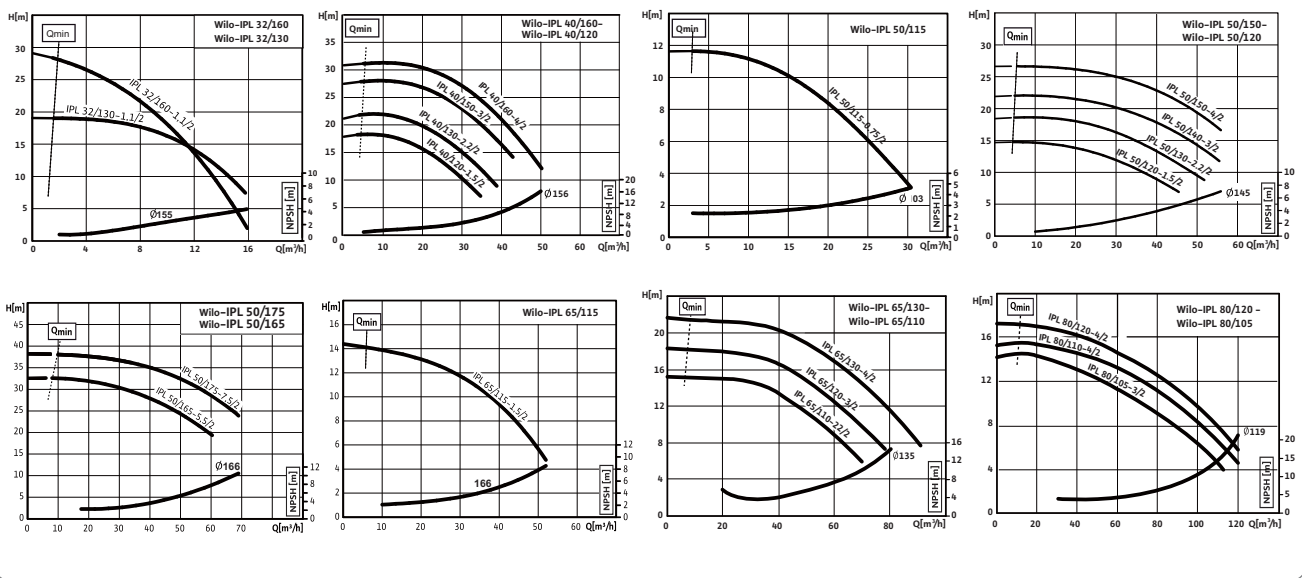

Specification 详述

	IPL 32	IPL 40	IPL 50	IPL 65	IPL 80
Electrical connection 电气连接					
Power source 电源参数	3~400V/50Hz				
Applications 应用场合					
Approved fluids 输送介质	Clean water 清水				
Fluid temp (°C) 介质温度	-20 ~ +120				
Max pressure (bar) 最大承压	10bar				
Protection class 防护等级	IP55				
Materials 材质					
Casing 泵体	Cast Iron 铸铁				
Impeller 叶轮	Plastic 工程塑料 (功率 ≤ 4kw) Cast Iron 铸铁 (功率 ≥ 5.5kw)				
Shaft 轴	Stainless Steel 不锈钢				
Mechanical seal 机械密封	Carbon & Silicon Carbide 石墨 & 碳化硅				

Outline drawing/外形图

IPL Series

Dimension drawing A 外形尺寸图 A

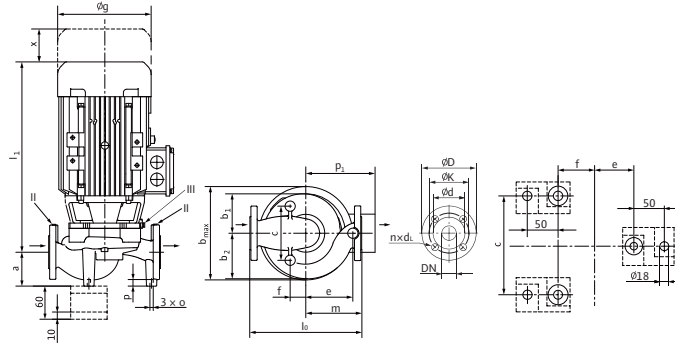

Dimension drawing B 外形尺寸图 B

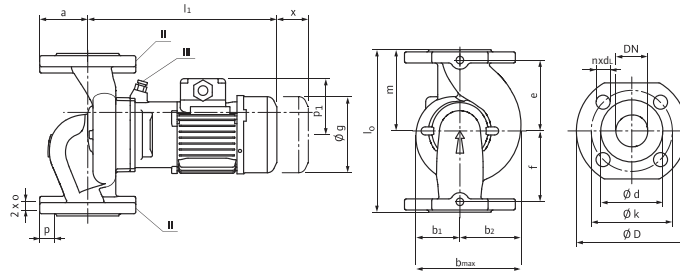

Note: Housing with feet for installation on a base, brackets on request; II Pressure measuring connection R¹/₈; III Ventilation R¹/₈

注意: 泵体安装在底座上, 支脚供选配; II侧压口R¹/₈; III排气口R¹/₈

Wilo-IPL	Rating power 额定功率	Rating current 额定电流	Flange diameter 法兰直径	Dimensions 外形尺寸																Impeller 叶轮	Weight approx 重量	Dimensions drawing 外形尺寸图
	[kw]	A	DN	l ₀	a	b ₁	b ₂	b _{max}	c	e	f	Øg	l _{1max}	m	o	p	p ₁	x	-	m		
	[mm]																-	[kg]				
32/130-1.1/2	1.1	2.40	32	260	70	101	106	207	90	40	50	185	341	130	M10	20	128	150	P	26	A	
32/160-1.1/2	1.1	2.40	32	260	70	101	106	207	90	40	50	185	341	130	M10	20	128	150	P	26	A	
40/120-1.5/2	1.5	3.30	40	320	75	113	121	234	90	40	50	193	374	160	M10	20	151	150	P	30	A	
40/130-2.2/2	2.2	4.52	40	320	75	113	121	234	90	40	50	193	374	160	M10	20	151	150	P	32	A	
40/150-3/2	3	5.80	40	320	75	113	121	234	90	40	50	217	386	160	M10	20	160	150	P	38	A	
40/160-4/2	4	7.70	40	320	75	113	121	234	90	40	50	232	420	160	M10	20	169	150	P	44	A	
50/115-0.75/2	0.75	1.70	50	280	75	91	101	192	-	125	125	146	346	140	M10	20	128	150	P	27	B	
50/120-1.5/2	1.5	3.30	50	340	86	116	131	247	104	40	50	193	376	170	M10	20	151	150	P	33	A	
50/130-2.2/2	2.2	4.52	50	340	86	116	131	247	104	40	50	193	376	170	M10	20	151	150	P	35	A	
50/140-3/2	3	5.80	50	340	86	116	131	247	104	40	50	217	388	170	M10	20	160	150	P	41	A	
50/150-4/2	4	7.70	50	340	86	116	131	247	104	40	50	232	422	170	M10	20	169	150	P	47	A	
50/165-5.5/2	5.5	10.20	50	340	103	120	138	279	164	143	48	279	526	170	M10	20	188	150	Cl	74	A	
50/175-7.5/2	7.5	13.70	50	340	103	120	138	279	164	143	48	279	526	170	M10	20	188	150	Cl	76	A	
65/115-1.5/2	1.5	3.30	65	340	80	100	118	218	-	155	155	193	387	170	M10	20	151	150	P	35	B	
65/110-2.2/2	2.2	4.62	65	340	93	111	132	243	135	32	63	193	379.5	162	M10	20	149.5	150	P	37	A	
65/120-3/2	3	6.17	65	340	93	111	132	243	135	32	63	217	414.0	162	M10	20	169.5	150	P	43	A	
65/130-4/2	4	7.70	65	340	93	111	132	243	135	32	63	232	445.5	162	M10	20	174.5	150	P	51	A	
80/105-3/2	3	6.17	80	360	105	125	157	282	135	40	55	217	421.5	180	M10	20	169.5	150	Cl	48	A	
80/110-4/2	4	7.70	80	360	105	125	157	282	135	40	55	232	453	180	M10	20	174.5	150	P	57	A	
80/120-4/2	4	7.70	80	360	105	125	157	282	135	40	55	232	453	180	M10	20	174.5	150	P	57	A	

Wet motor pump/湿转子泵(屏蔽泵)



Stratos-ECO 25/1-5



Stratos-PICO

The high efficiency pump/ 高能泵

Stratos-ECO 25/1-5

Feature/特征:

- Energy efficiency class A/A级能效
- Regulation Δ PV & ECM technology, energy saving 80%/变压力调节和ECM技术, 节能可达80%
- Reduces water circulation noise in the installation/减小装置噪音
- Automatic de-jamming system : the SIRIUX Jr. switches to maximum torque when it detects an abnormal slowdown of the pump + vibration/自动抗干扰系统, 当出现卡转现象时, 会自动切换到最大扭矩并同时震动, 以清除杂质

Application/应用:

- Radiator, floor heating system/散热器, 地板采暖系统
- Industrial circulation systems/工业循环系统

The high efficiency pump/ 高能泵

Stratos PICO 15/1-4, 25/1-4, 30/1-4, 15/1-6, 25/1-6, 30/1-6

Feature/特征:

- High-efficiency pump for energy saving, rated energy efficiency class A/世界上最高效节能的水泵, A级能效产品领跑者
- Reliable starting and maximum convenience due to high starting torque and deblocking software/采用最大启动扭矩输出和抗卡转设计, 启动运行更加可靠
- Display with consumption reading/液晶屏同步显示功率消耗及操作信息
- Thermal insulation shell for heating applications as standard/一体化设计的绝缘保温壳

Application/应用:

- Warm water radiators in all systems in single and two-family houses/适用于单独住宅或联排住宅热水采暖系统
- air-conditioning applications/空调系统
- industrial circulation systems/工业循环系统

Performance curve/性能曲线

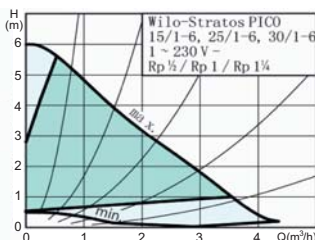
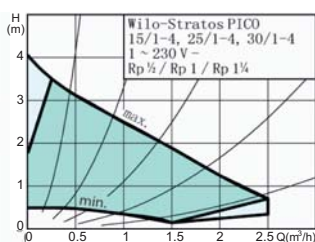
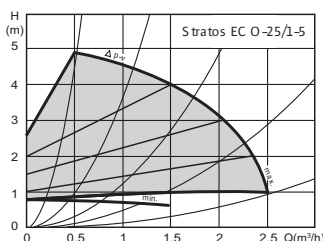

Specification 详述

	Stratos-ECO 25/1-5	PICO 15/1-4, 25/1-4, 30/1-4	PICO 15/1-6, 25/1-6, 30/1-6
Electrical connection 电气连接			
Power source 电源参数	1~220V/50Hz		
Input power P ₁ (W) 输入功率	59	20	40
Applications 应用场合			
Approved fluids 输送介质	Clean water 清水		
Fluid temp (°C) 介质温度	15 ~ 110	2 ~ 110	
Performance data 性能参数			
Max head (m) 最大扬程	5	4	6
Max flow (l/min) 最大流量	42	42	69
Inlet size (mm) 进口尺寸	25	15/25/30	
Outlet size (mm) 出口尺寸	25	15/25/30	
Max pressure (bar) 最大承压	10	10	
Protection class 防护等级	IP44	IP44	
Weight (kg) 重量	2.6	2.2	2.2
Materials 材质			
Casing 泵体	Cast Iron(Brass) 铸铁(黄铜)	Cast Iron 铸铁	
Impeller 叶轮	Plastic 工程塑料		
Shaft 轴	Stainless Steel 不锈钢		

Wet motor pump/湿转子泵(屏蔽泵)



The automatic pump/自适应泵 Smart 25/6

Feature/特征:

- Energy efficiency class B/B级能效
- △PC for constant differential pressure/恒定压差控制
- Adjusts automatically its speed to the requirements /自动调节转速
- Detection of Thermal Disinfections /减小装置噪音
- Automatic de-jamming system : the SIRIUX Jr. switches to maximum torque when it detects an abnormal slowdown of the pump/自动抗干扰系统，当出现卡转现象时，会自动切换到最大扭矩，以清除杂质

Application/应用:

- Hot water heating systems of all kinds/热水采暖系统
- Industrial circulation systems/工业循环系统

The pump with time & temperature controller/温度时间控制泵 Star-Z15TT, RS-T15/6

Feature/特征:

- Time and temperature controller(Z15TT), temperature controller(RS-T)/时间温度控制 (Z15TT)，温度控制 (RS-T)
- Detection of thermal disinfections(Z15TT)/检测高温消毒 (Z15TT)
- Liquid crystal display(Z15TT)/液晶显示屏 (Z15TT)
- With temperature sensor in control box/控制盒中带有温度传感器，无需额外安装
- Sanitary loop Length(Z15TT): up to (50)100m for (not) isolated pipe/管道长度，(未)保温时可达 (50) 100m (Z15TT)

Application/应用:

- Accelerated circulation in the hot water supply system/卫生用水加速循环，使一开水龙头就有热水
- Secondary hot water circulation systems and similar systems in industrial and building services/二次热水循环系统和类似的工业和建筑应用

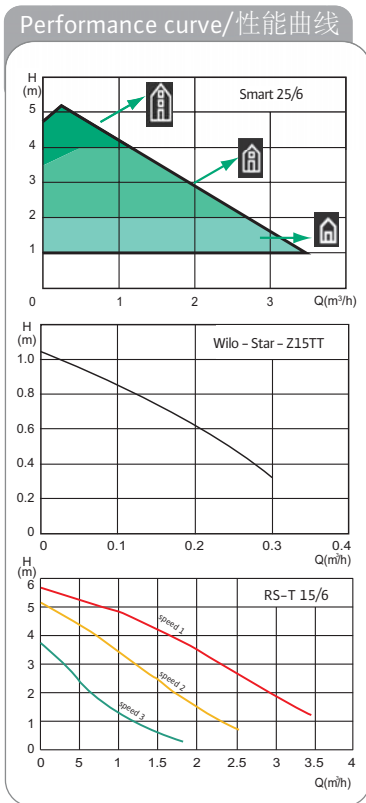

Specification 详述

	Smart 25/6	Z15TT	RS-T 15/6
Electrical connection 电气连接			
Power source 电源参数	1~220V/50Hz		
Input power P ₁ (W) 输入功率	72	22	93/67/46
Applications 应用场合			
Approved fluids 输送介质	Clean water 清水		
Fluid temp (°C) 介质温度	2 ~ 95	20 ~ 65	2 ~ 95
Performance data 性能参数			
Max head (m) 最大扬程	6	1	6/5/3
Max flow (l/min) 最大流量	55	5	57/41/25
Inlet size (mm) 进口尺寸	25	15	15
Outlet size (mm) 出口尺寸	25	15	15
Max pressure (bar) 最大承压	10	10	10
Protection class 防护等级	IP42	IP42	IP42
Weight (kg) 重量	2.9	2.1	2.1
Materials 材质			
Casing 泵体	Cast Iron 铸铁	Brass 黄铜	Cast Iron 铸铁
Impeller 叶轮	Plastic 工程塑料		
Shaft 轴	Stainless Steel 不锈钢		Ceramic 陶瓷

Wet motor pump/湿转子泵(屏蔽泵)



RS15/6, RS25/6, RS25/8



RL25/7.5



TOP-S25/13EM



TOP-S40/15DM



ST20/11

The standard pump/标准泵

RS15/6, RS25/6, RS25/8, RL25/7.5, TOP-S25/13EM, TOP-S40/15DM, ST20/11

Feature/特征:

Wet motor pump, low noise/屏蔽泵, 噪音低

There pre-selectable speed stages for power adjustment/可三档调速

Electrical connections possible on both sides of the terminal box/可从接线盒任意一侧接线

Terminal Box position: 3h; 6h; 9h; 12h/接线盒可四方为旋转, 以适应各种安装

Application/应用:

Hot water heating systems of all kinds/热水采暖系统

Industrial circulation systems/工业循环系统

Cold water system and air-conditioning systems/冷水和空调系统

Roof tank to water tap transfer(ST20/11 with flow switch)/屋顶水箱向下供水增压(ST20/11配流量开关)

Specification 详述

	RS15/6	RS25/6	RS25/8	RL25/7.5	TOP-S 25/13EM	TOP-S 40/15DM	ST20/11
Electrical connection 电气连接							
Power source 电源参数	1~220V/50Hz					3~380V/50Hz	1~220V/50Hz
Input power P ₁ (W) 输入功率	93/67/46	93/67/46	151/113/81	205/165/115	260/200/130	925/745/600	165/110/67
Applications 应用场合							
Approved fluids 输送介质	Clean water 清水						
Fluid temp (°C) 介质温度	-10 ~ +110			-10 ~ +130	-20 ~ +110	-20 ~ +130	-10 ~ +110
Performance data 性能参数							
Total head (m) 全扬程	6/5/3	6/5/3	7.8/6.8/4.8	7.5/7/5.6	13.6/11.8/6	15/13.9/12.4	11/7/3.5
Max flow (l/min) 最大流量	57/41/25	57/41/25	100/66/41	100/83/50	53/35/23	360/316/283	42/27/19
Inlet size (mm) 进口尺寸	15	25	25	25	25	40	20
Outlet size (mm) 出口尺寸	15	25	25	25	25	40	20
Max pressure (bar) 最大承压	10	10	10	10	10	10/16	10
Protection class 防护等级	IP42	IP42	IP42	IP44	IP44	IP44	IP42
Weight (kg) 重量	2.1	2.4	3.8	3.8	5.5	18	3
Materials 材质							
Casing 泵体	Cast Iron 铸铁						
Impeller 叶轮	Plastic 工程塑料						
Shaft 轴	Stainless Steel 不锈钢						

Performance curve/性能曲线

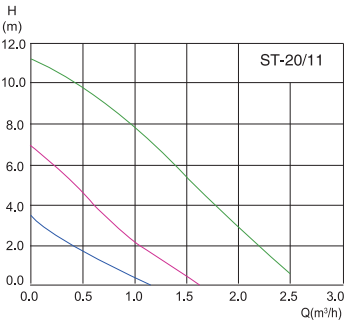
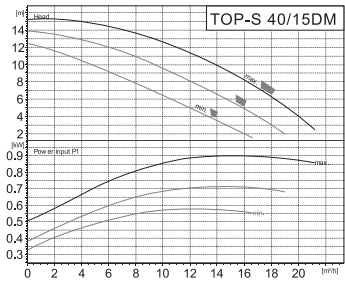
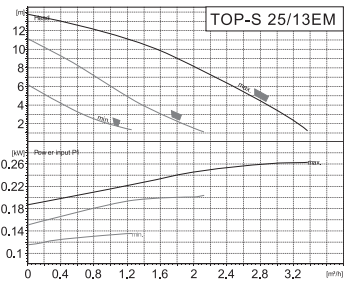
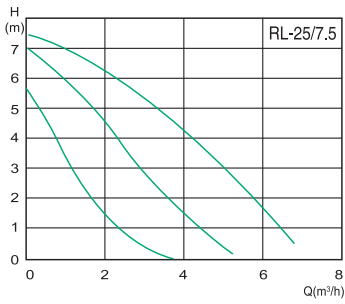
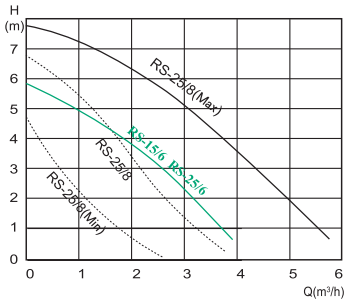

Outline drawing/外形图

Stratos-ECO 25/1-5

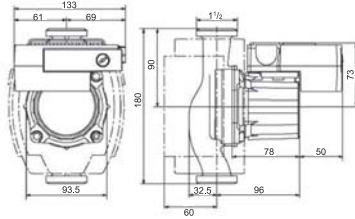

Stratos-PICO

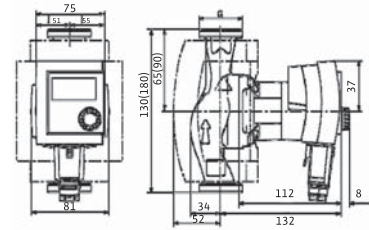

Smart 25/6, RS-T 15/6

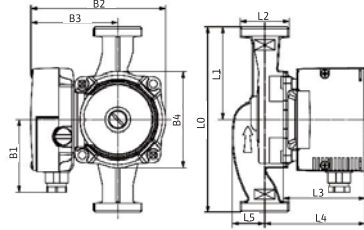

型号(Model)	L0	L1	L2	L3	L4	L5	B1	B2	B3	B4
Smart 25/6	180	90	25	79	97	34	88	117	71	93.5
RS-T 15/6	130	65	25	78	96	27.5	-	-	-	93.5

Star-Z15TT

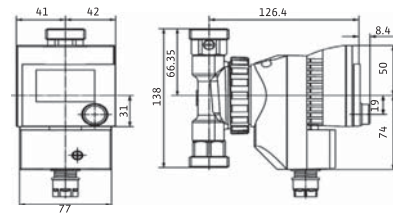

RS15/6, RS25/6, RS25/8

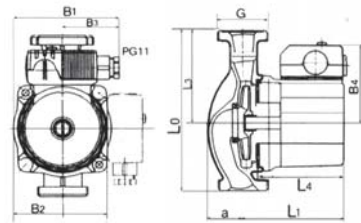

型号(Model)	L0	L1	L3	L4	a	B1	B2	B3	B4	G
RS15/6	130	97	65	79	23	100	92.5	54	76	1"
RS25/6	130	97	65	79	23	100	92.5	54	76	1"1/2
RS25/8	180	118	90	79	32	119	118	60	76	1"1/2

RL25/7.5

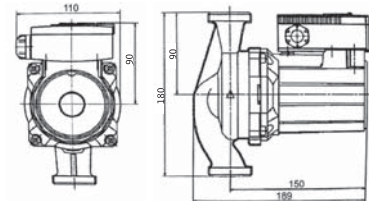

TOP-S25/13EM, TOP-S40/15DM

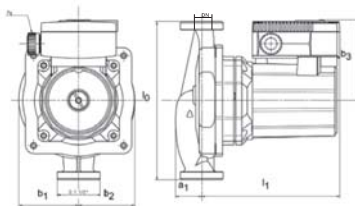

型号(Model)	f0	f1	a1	b1	b2	b3
TOP-S25/13EM	180	156	57	67.5	63.5	92
TOP-S40/15DM	250	258	83	99	-	120

ST20/11

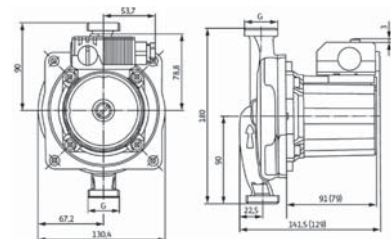

Sea water application / 海水应用



PU-S400E



PD-S Series

For surface / 水面安装

PU-S400E

Feature / 特征:

- Light / 重量轻
- Portable by lifting handle (PU-S400E only) / 便携式提手 (仅PU-S400E)
- Durable against seawater / 耐海水腐蚀材料

Application / 应用:

Various seawater application, agricultural application / 各种海水应用, 农业应用

For submersible / 水下安装

PD-S401E(A)/S751E(A)

Feature / 特征:

- Corrosion-resistant by aluminum galvanic anode / 通过铝阳极保护, 耐腐蚀
- Leak-proof design-double mechanical seal / 双向机封, 不泄漏
- Automatic operation by float switches (EA series only) / 通过浮球开关自动运行 (EA系列)

Application / 应用:

Sea water drainage application (aquarium, fish farm, etc) / 海水潜水应用 (养鱼缸, 渔场等)

Performance curve / 性能曲线

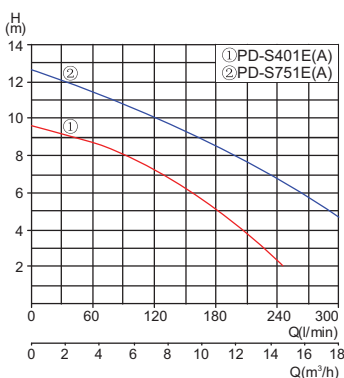
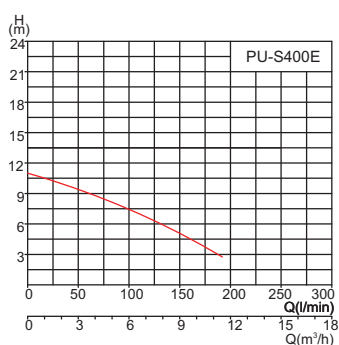

Specification 详述

	PU-S400E	PD-S401E(A)	PD-S751E(A)
Electrical connection 电气连接			
Power source 电源参数	1~220V/50Hz		
Input power P ₁ (W) 输入功率	600	510	950
Output power P ₂ (W) 输出功率	400	400	750
Applications 应用场合			
Approved fluids 输送介质	Sea water 海水		
Fluid temp (°C) 介质温度	0 ~ 40		
Performance data 性能参数			
Total head (m) 全扬程	9	9	12
Max suction (m) 最大吸程	6	-	-
Max flow (l/min) 最大流量	160	225	300
Rated flow (l/min) 额定流量	110	150	220
Rated head (m) 额定扬程	7	5	7
Inlet size (mm) 进口尺寸	40	-	-
Outlet size (mm) 出口尺寸	40	50	50
Max pressure (bar) 最大承压	3.0	1.5	2.1
Protection class 防护等级	IP44	IP68	IP68
Weight (kg) 重量	12	15	17
Materials 材质			
Casing 泵体	Plastic 工程塑料		
Impeller 叶轮	Bronze 青铜	Plastic 工程塑料	
Shaft 轴	Stainless Steel 不锈钢		
Mechanical seal 机械密封	Carbon & Ceramic 石墨&陶瓷		

Magnet pump/化学泵



Magnet pump/化学泵

PM-016PE/030PE/052PE/150PE/250PE

Feature/特征:

Rust-proof materials/耐腐蚀材料
 Long-lasting and no leakage by adopting a closed motor/非封闭式磁力驱动系统，寿命长，无泄漏

Application/应用:

Hot water transfer/热水输送
 Chemical liquid transfer/化学液体输送
 Etching equipment for electronic parts, dyeing equipment, etc/电子零配件刻蚀，印染等设备
 Laboratory and pilot plant, etc/研究所及实验室等

Performance curve/性能曲线

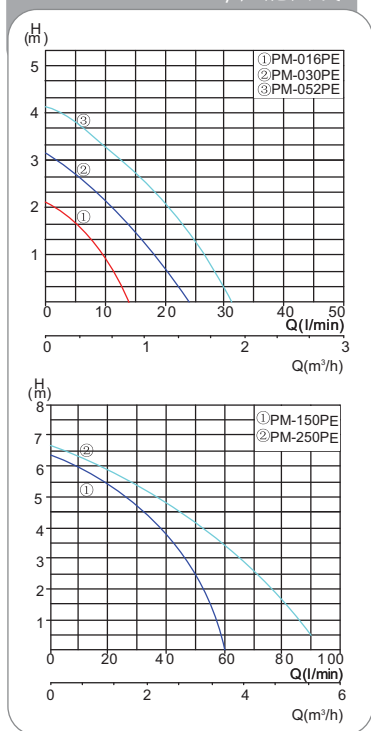

Specification 详述

	PM-016PE	PM-030PE	PM-052PE	PM-150PE	PM-250PE
Electrical connection 电气连接					
Power source 电源参数	1~220V/50Hz				
Input power P ₁ (W) 输入功率	27	40	95	230	350
Output power P ₂ (W) 输出功率	15	30	50	150	250
Applications 应用场合					
Approved fluids 输送介质	Chemical liquid 化学液体				
Fluid temp (°C) 介质温度	0 ~ 60				
Performance data 性能参数					
Max head (m) 最大扬程	2	2.5	4	5.5	6
Max flow (l/min) 最大流量	14	20	32	65	100
Rated flow (l/min) 额定流量	12	15	20	30	50
Rated head (m) 额定扬程	1	1.5	2	4	4
Inlet size (mm) 进口尺寸	14	17	20	20	25
Outlet size (mm) 出口尺寸	14	17	20	20	25
Max pressure (bar) 最大承压	2	2.5	4	5.5	6
Protection class 防护等级	14	20	32	65	150
Weight (kg) 重量	2.5	3.6	3.8	8.5	12
Materials 材质					
Casing 泵体	Poly propylene + Glass fibre 聚丙烯+玻璃纤维				
Impeller 叶轮	Poly propylene + Ferrite 聚丙烯+铁酸盐				
Shaft 轴	Ceramic 陶瓷				

Outline drawing/外形图

PU-S400E

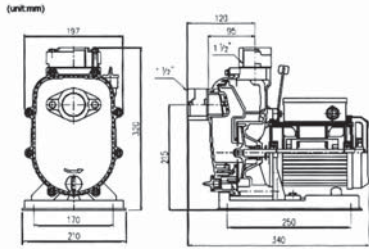

PD-S401E(A)

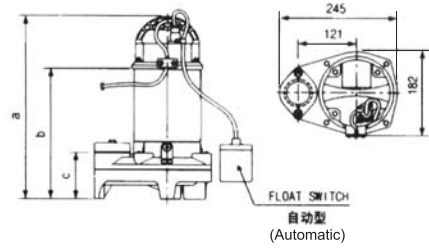

Model/型号	a	b	c
PD-S401E(A)	391	273	86

PD-S751E(A)

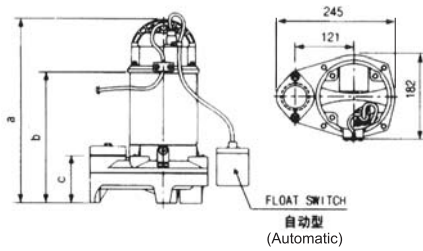

Model/型号	a	b	c
PD-S751E(A)	416	218	86

PM-016PE/030PE

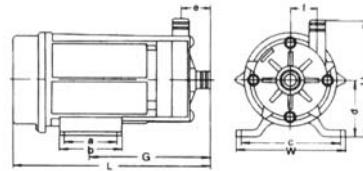

型号(Model)	w	L	G	H	a	b	c	d	e	f
PM-016PE	107	193	117	111	44	60	85	55	29	26
PM-030PE	106	217	147	117	44	60	90	54	38	26

PM-052PE

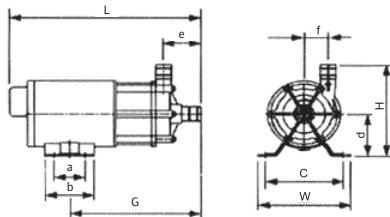

型号(Model)	w	L	G	H	a	b	c	d	e	f
PM-052PE	120	244	169	130	40	64	100	60	48	31

PM-150PE/250PE

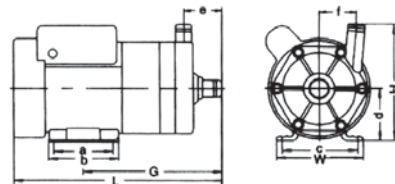

型号(Model)	w	L	G	H	a	b	c	d	e	f
PM-016PE	112	274	178	154	70	104	89	69	48	50
PM-030PE	144	370	367	166	90	106	112	71	74	47

Wastewater lifting unit/污水提升系统



Hisewlift 3-15



Hisewlift 3-35



Hisewlift 3-I35

With macerator/带切碎刀

Hisewlift 3-15/3-35/3-I35

Feature/特征:

Automatically operating small lifting unit with macerator/自动运行的带切碎刀的微型污水提升器

Connected directly to a toilet basin with a horizontal or vertical connection port/横向或纵向连接端口, 可直接与坐便器连接

Odour-free exhaust ventilation into the room is carried out by an active carbon filter/内置活性炭过滤器, 可有效吸收异味

Self-sealing, compact structure, space-saving design/自密封, 结构紧凑, 节省空间

Application/应用:

With macerator for disposing the sewage from an individual toilet/带切碎刀, 可与坐便器直接连接

Wastewater lifting unit for automatic sewage of individual toilet, wash basin, shower, etc/自动提升坐便器, 洗手盆, 淋浴房等产生的生活污水

Specification 详述

	Hisewlift 3-15	Hisewlift 3-35	Hisewlift 3-I35
Electrical connection 电气连接			
Power source 电源参数	1 ~ 220(240) V/ 50Hz		
Rated current (A) 额定电流	1.9	1.9	1.9
Applications 应用场合			
Fluid temp (°C) 介质温度	5 ~ 35	5 ~ 35	5 ~ 35
Performance data 性能参数			
Max head (m) 最大扬程	5@0.7l/s	5@0.7l/s	5@0.7l/s
Inlet size (mm) 进口尺寸	40	40	40
Outlet size (mm) 出口尺寸	32/28/22	32/28/22	32/28/22
Number of inlets 进口数量	1 for toilet +1 1个坐便器接口+1个其它接口	1 for toilet +3 1个坐便器接口+3个其它接口	1 for toilet +3 1个坐便器接口+3个其它接口
Protection class 防护等级	IP44	IP44	IP44
Materials 材质			
Impeller 叶轮	Plastic 工程塑料		
Tank 水箱	Plastic 工程塑料		

Performance curve/性能曲线

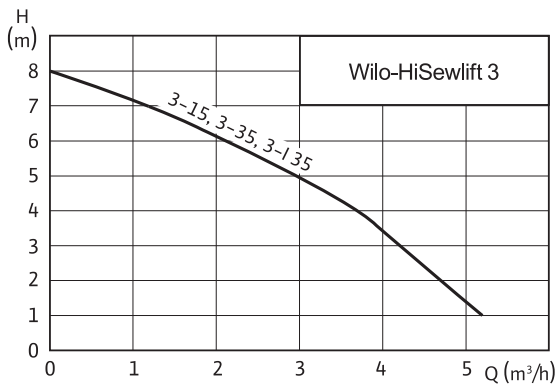

Outline drawing/外形图

HiSewlift3-15

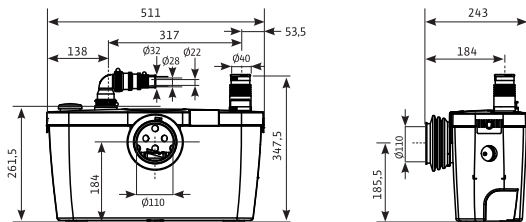

HiSewlift3-35

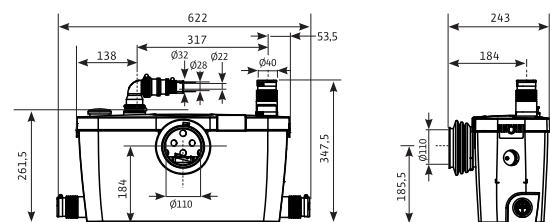

HiSewlift3-135

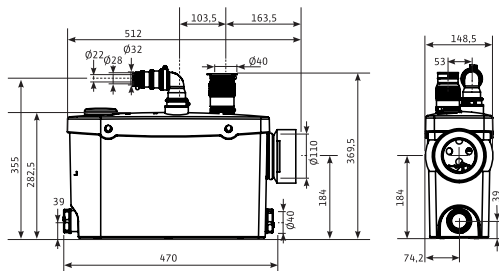

Wastewater lifting unit/污水提升系统



HiDrainlift 3-24



HiDrainlift 3-35



HiDrainlift 3-37



TMP40/8, TMP40/11

Without macerator/不带切碎刀

HiDrainlift 3-24/3-35/3-37, TMP40/8, TMP40/11

Feature/特征:

Reliable drainage lifting performance, lower power consumption, lower noiser/可靠的污水提升性能, 功耗更低, 噪音更低

Odour-free exhaust ventilation into the room is carried out by an active carbon filter/内置活性炭过滤器, 可有效吸收异味

Self-sealing, compact structure, space-saving design/自密封, 结构紧凑, 节省空间

Application/应用:

Wastewater lifting unit for automatic drainage of wash basin, shower, bath, washing machines, dishwashers, etc/自动提升洗手盆, 淋浴房, 浴盆, 洗衣机, 洗碗机产生的生活污水

Drainage of rooms, garage entrances and cellar stairways/房间的污水, 停车库入口的污水及地窖楼梯间的污水

Specification 详述

	HiDrainlift 3-24	HiDrainlift 3-35	HiDrainlift 3-37	TMP 40/8	TMP 40/11
Electrical connection 电气连接					
Power source 电源参数	1~220V/50Hz				
Rated current (A) 额定电流	1.22	1.7	2	2.1	3.6
Applications 应用场合					
Approved fluids 输送介质	Drainage water 污水				
Fluid temp (°C) 介质温度	5 ~ 35	5 ~ 60 (最高温)	5 ~ 75 (最高温)	0 ~ 35	0 ~ 35
Performance data 性能参数					
Max head (m) 最大扬程	4@0.7l/s	5@0.7l/s	7@0.7l/s	8	10
Inlet size (mm) 进口尺寸	40	40	40	25/32/40	25/32/40
Outlet size (mm) 出口尺寸	32	32	32	40	40
Protection class 防护等级	IP44	IP44	IP44	IP67	IP67
Materials 材质					
Impeller 叶轮	Plastic 工程塑料				
Tank 水箱	Plastic 工程塑料				

Performance curve/性能曲线

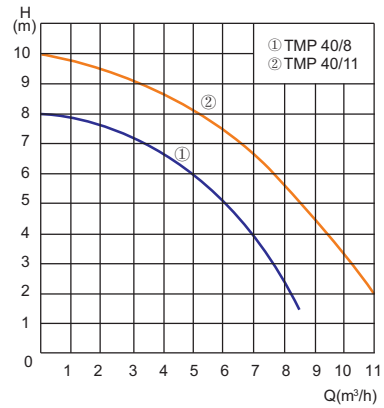
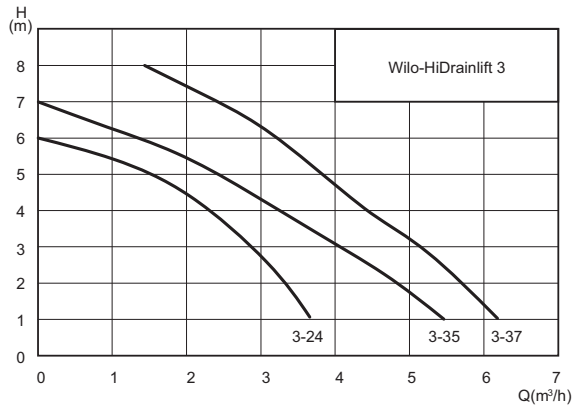

Outline drawing/外形图

HiDrainlift 3-24

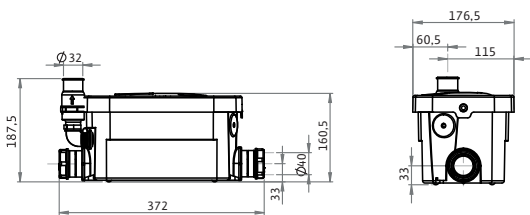

HiDrainlift 3-35

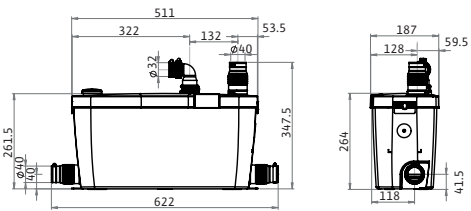

HiDrainlift 3-37

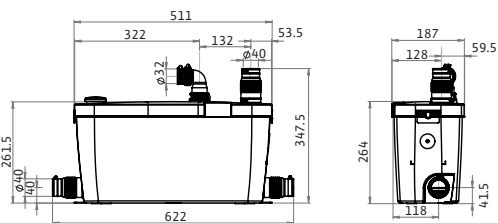

TMP40/8, TMP40/11

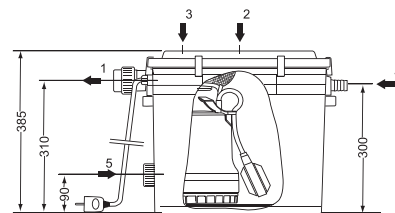

- 1=Pressure pipe DN40 出水管路 DN40
- 2=Ventilation DN32 排气孔 DN32
- 3=Feed line DN 32(wash basin) DN 32 (洗脸盆)
- 4=Feed line DN 25(washing machine) DN 25 (洗衣机)
- 5=Feed line DN 40(shower) 进水口DN 40 (淋浴)

Submersible/水下安装



PD-G050E(A)



PD-180E(A)/300E(A)



PD-A Series, PDV Series



STS Series



PDN Series

Clean water drain/清水潜水泵

PD-G050E(A)/180E(A)/300E(A)/A401E(A)/A751E(A)

Feature/特征:

Automatic operation by float switch (EA series only)/通过浮控开关自动运行(EA系列)
Dewatering very low water level/残余水量低
Rust-proof materials/耐腐蚀材料

Application/应用:

Fountain, clean water drainage application/喷泉, 清水排水系统
Water supply from wells and rivers/水井和河流向上供水

Sewage water drain/污水潜水泵

PDV-A400E(A)/A750E(A), STS40/8(A), STS40/10(A), PDN-1500Q/2200Q/3700Q/5500Q/7500Q

Feature/特征:

Vortex impellers/涡流叶轮
Free ball passage: 32mm(40mm for STS series)/可自由通过球状颗粒32mm(STS系列 40mm)
Automatic operation by float switch (for EA model only)/通过浮控开关自动运行(EA 系列)。
Rust proof materials/耐腐蚀材料

Application/应用:

Wastewater, clean water drainage/废水, 清水排水
Pumping of rain water, seepage water, etc/抽取雨水, 积水等
Pumping thick water form cesspools, ditches, sewers/从污水沟, 坑, 下水道抽水
Transferring thick water containing large solids/输送含较大颗粒的污水

Specification 详述

	PD-G050E(A)	PD-180E(A)	PD-300E(A)	PD-A401E(A)	PD-A751E(A)	PDV-A400E(A)	PDV-A750E(A)	STS40/8(A)	STS40/10(A)	PDN-1500Q	PDN-2200Q	PDN-3700Q	PDN-5500Q	PDN-7500Q	
Electrical connection 电气连接								1~220V/50Hz		1~220V(3~380)/50Hz		3~380V/50Hz			
Power source 电源参数	1~220V/50Hz							1~220V(3~380)/50Hz		3~380V/50Hz					
Input power P ₁ (W) 输入功率	120	270	380	600	950	600	950	800	1000	-	-	-	-	-	
Output power P ₂ (W) 输出功率	50	180	300	400	750	400	750	600	750	1500	2200	3700	5500	7500	
Applications 应用场合								Clean water 清水		Sewage water 污水					
Approved fluids 输送介质	Clean water 清水							Sewage water 污水							
Fluid temp(°C) 介质温度	0 ~ 40														
Max. particle size 最大通过颗粒	5	2	2	10	10	32	32	40	40	24	24	48	50	50	
Performance data 性能参数															
Max head (m) 最大扬程	3.5	5.5	7.5	9	12	7	10	8	10	15	18	15	19	21	
Rated flow (l/min) 额定流量	45	75	120	150	220	150	220	-	-	400	400	800	800	800	
Rated head (m) 额定扬程	1	2.5	4	5	7	4	6	-	-	6.5	9	7	10	13.5	
Outlet size (mm) 出口尺寸	15/20/25	20/25/32	25/32	50	50	50	50	40	40	65(80)	65(80)	65(80)	80(100)	80(100)	
Protection class 防护等级	IP68	IPX8	IPX8	IP68	IP68	IP68	IP68	IP68	IP68	IP68	IP68	IP68	IP68	IP68	
Weight (kg) 重量	5.1	5.2	5.4/5.6	13	15	13.5	14.5	21	21	50	55	100	130	131	
Materials 材质															
Casing 泵体	Plastic 工程塑料							Cast Iron 铸铁							
Impeller 叶轮	Plastic 工程塑料				Brass 黄铜			Stainless Steel 不锈钢		Cast Iron 铸铁					
Shaft 轴	Stainless Steel 不锈钢														
Mechanical seal 机械密封	SIC & SIC 碳化硅&碳化硅		Carbon & Ceramic 石墨&陶瓷		SIC & SIC 碳化硅&碳化硅			Carbon & Ceramic 石墨&陶瓷		SIC & SIC 碳化硅&碳化硅					

Performance curve/性能曲线

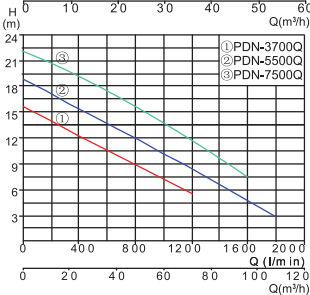
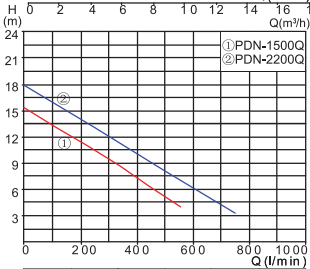
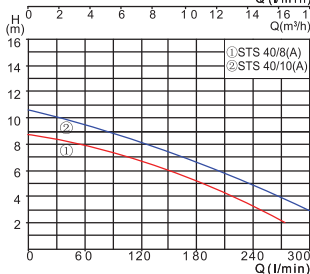
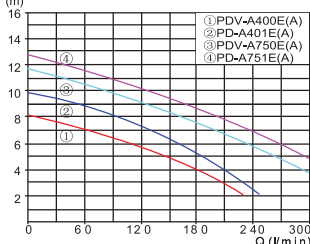
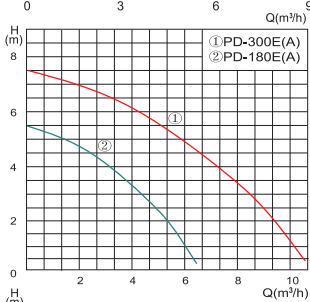
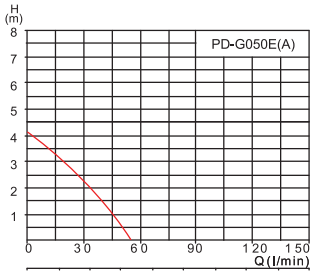

Outline drawing/外形图

PD-G050E(A)

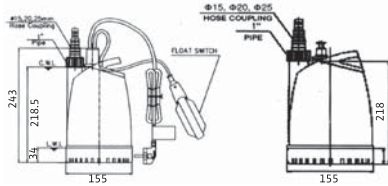

PD-180E(A)/300E(A)

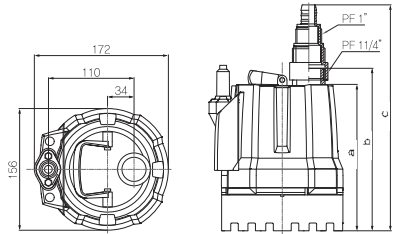

型号 (Model)	a	b	c
PD-180E(A)	180	201	282
PD-300E(A)	180	201	282

PD-A, PDV-A Series

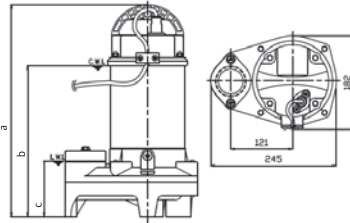

型号 (Model)	a	b	c
PDV-A400E(A)	411	293	106
PD-A401E(A)	391	273	86
PDV-A750E(A)	436	318	106
PD-A751E(A)	416	298	86

STS Series

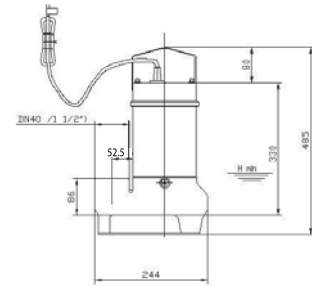

PDN-1500/2200 Series

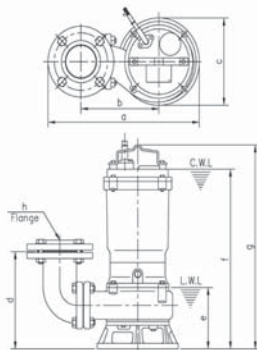

型号 (Model)	a	b	c	d	e	f	g	h
PDN-1500Q	426	219	228	254	160	468	530	80mm(3")
PDN-2200Q	426	219	228	254	160	468	530	PF3"(80mm)

PDN-3700/5500/7500 Series

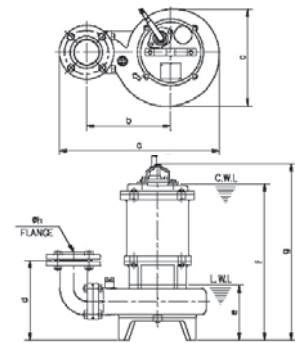

型号 (Model)	a	b	c	d	e	f	g	h
PDN-3700Q	546	287	332	270	187	534	601	PF3"(80mm)
PDN-5500Q	636	337	388	271	189	654	710	PF4"(100mm)
PDN-7500Q	636	337	388	271	189	654	710	PF4"(100mm)

4.1 DRAINAGE, SEWAGE, DRAIN LIFT/排水, 污水, 污水提升

Submersible/水下安装

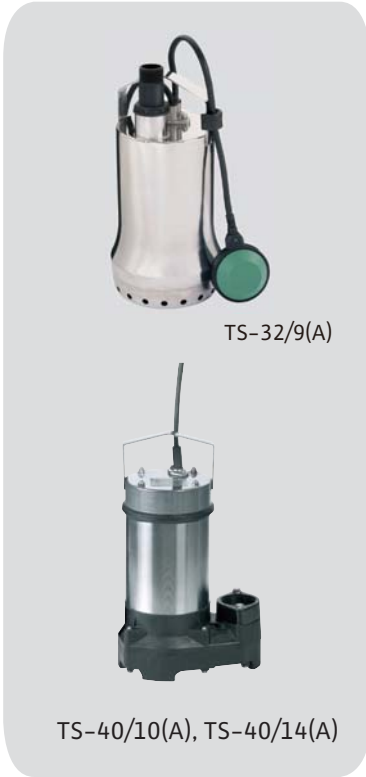

Clean water drain/清水潜水泵

TS-32/9(A), TS-40/10(A), TS-40/14(A)

Feature/特征:

Dewatering very low water level/ 残余水量低
Rust-proof materials/耐腐蚀材料

Application/应用:

Fountain, clean water drainage application/ 喷泉, 清水排水系统
Water supply from wells and rivers/ 水井和河流向上供水

Outline drawing/外形图

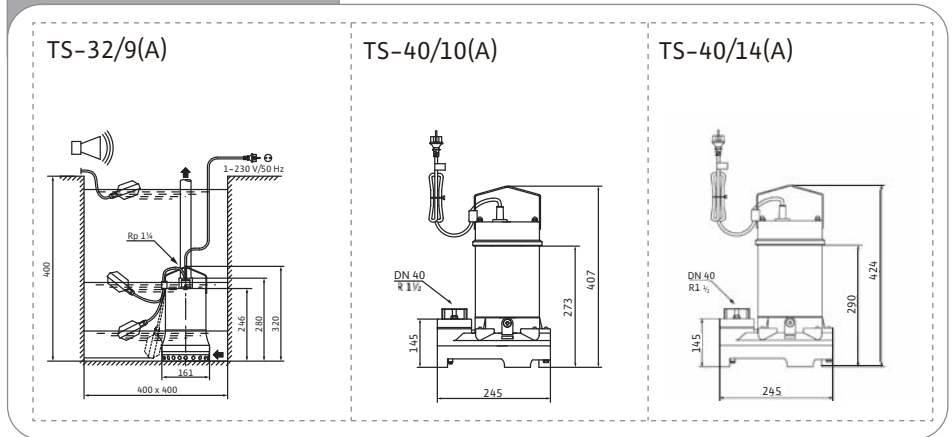

Performance curve/性能曲线

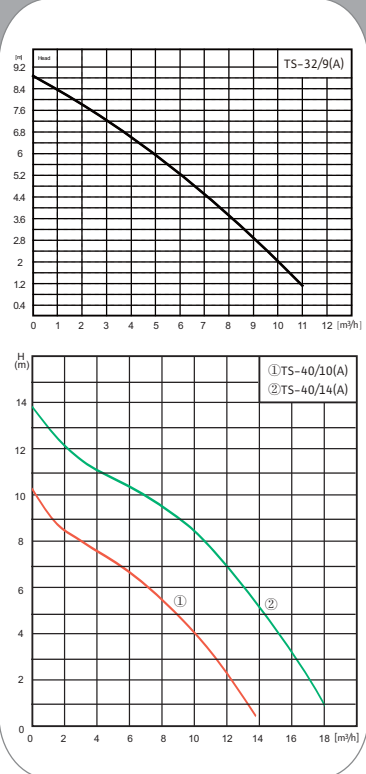

Specification 详述

	TS-32/9(A)	TS-40/10(A)	TS-40/14(A)
Electrical connection 电气连接			
Power source P (W) 电源参数		1~220V/50Hz	
Output power P ₂ (W) 输出功率	550	400	750
Applications 应用场合			
Approved fluids 输送介质	Clean water 清水		
Fluid temp(°C) 介质温度	0~35		
Performance data 性能参数			
Max head (m) 最大扬程	8.5	10	14
Max flow (l/min) 最大流量	183	230	300
Outlet size (mm) 出口尺寸	32	40	40
Max pressure (bar) 最大承压	1.3	1.8	2.1
Weight (kg) 重量	6.8	14	15
Protection class 防护等级	IP68		
Materials 材质			
Casing 泵体	Stainless Steel 不锈钢	Plastic 工程塑料	
Impeller 叶轮	Plastic 工程塑料		
Shaft 轴	Stainless Steel 不锈钢		
Mechanical seal 机械密封	Carbon & Ceramic 石墨&陶瓷	SiC & SiC 碳化硅&碳化硅	

“威乐(wilo)的产品
节能降耗，技术领先，
服务更出色！”

